

Veflex

Band uit één stuk

Zuinige oplossing

band ook leverbaar in FRAS uitvoering

Zeer flexibel bij torsie

Zeer goede trillingsdemping



*FRAS = Fire resistant and antistatic

Technische gegevens

| Koppeling grootte | Nominale koppel [Nm] | Toerental [min ⁻¹] | Massa band [kg] | Massa flens [kg] | | |
|----------------------|-------------------------|-----------------------------------|-----------------------|------------------------|------|------|
| | | | | B | F | H |
| 40 | 24 | 4500 | 0,1 | 1 | 0,9 | 0,9 |
| 50 | 66 | 4500 | 0,3 | 1,7 | 1,1 | 1,1 |
| 60 | 127 | 4000 | 0,5 | 2,7 | 1,9 | 1,9 |
| 70 | 250 | 3600 | 0,7 | 3,3 | 2,4 | 2,6 |
| 80 | 375 | 3100 | 1 | 5,2 | 3,6 | 3,8 |
| 90 | 500 | 3000 | 1,1 | 7,7 | 5,5 | 5,5 |
| 100 | 675 | 2600 | 1,1 | 11 | 7 | 8 |
| 110 | 875 | 2300 | 1,4 | 13,5 | 9,3 | 9,3 |
| 120 | 1330 | 2050 | 2,3 | 19 | 12,7 | 13,6 |
| 140 | 2325 | 1800 | 2,6 | 23,3 | 23,4 | 23,4 |
| 160 | 3770 | 1600 | 3,4 | 37,6 | 34,1 | 34,1 |
| 180 | 6270 | 1500 | 7,7 | 51,6 | 44,3 | 44,3 |
| 200 | 9325 | 1300 | 8 | 61,1 | 56,3 | 56,3 |
| 220 | 11600 | 1100 | 10 | 83,6 | 75,6 | 75,6 |
| 250 | 14675 | 1000 | 15 | 109 | --- | --- |



Afmetingen

| Grootte | Type flens | Klembus ref | Max. boring [mm] | Flens F/H | | Flens B | | De [mm] | D1 [mm] | D2 [mm] | L1 [mm] | Schroeven | |
|---------|------------|-------------|------------------|-----------|---------|---------|---------|---------|---------|---------|---------|-----------|---|
| | | | | L [mm] | L2 [mm] | L [mm] | L2 [mm] | | | | | | |
| 40 | B | - | 32 | - | - | 33 | 22 | 104 | - | 82 | 11 | M5 | |
| | F | 1008 | 25 | 33 | 22 | - | - | | | | | | |
| | H | 1008 | 25 | 33 | 22 | - | - | | | | | | |
| 50 | B | - | 38 | - | - | 45 | 32 | 133 | 79 | 100 | 12,5 | M5 | |
| | F | 1210 | 32 | 38 | 25 | - | - | | | | | | |
| | H | 1210 | 32 | 38 | 25 | - | - | | | | | | |
| 60 | B | - | 45 | - | - | 55 | 38 | 165 | 70 | 125 | 16,5 | M6 | |
| | F | 1610 | 42 | 42 | 25 | - | - | | | | | | |
| | H | 1610 | 42 | 42 | 25 | - | - | | | | | | |
| 70 | B | - | 50 | - | - | 47 | 35 | 187 | 80 | 144 | 11,5 | M10 | |
| | F | 2012 | 50 | 44 | 32 | - | - | | | | | | |
| | H | 1610 | 42 | 42 | 25 | - | - | | | | | | |
| 80 | B | - | 60 | - | - | 55 | 42 | 211 | 97 | 167 | 12,5 | M10 | |
| | F | 2517 | 60 | 58 | 45 | - | - | | 95 | | | | |
| | H | 2012 | 50 | 45 | 32 | - | - | | 97 | | | | |
| 90 | B | - | 70 | - | - | 63,5 | 49 | 235 | 112 | 188 | 13,5 | M12 | |
| | F | 2517 | 60 | 59,5 | 45 | - | - | | 108 | | | | |
| | H | 2517 | 60 | 59,5 | 45 | - | - | | 108 | | | | |
| 100 | B | - | 80 | - | - | 70,5 | 56 | 254 | 125 | 216 | 13,5 | M12 | |
| | F | 3020 | 75 | 65,5 | 51 | - | - | | 120 | | | | |
| | H | 2517 | 60 | 59,5 | 45 | - | - | | 113 | | | | |
| 110 | B | - | 90 | - | - | 75,5 | 63 | 279 | 128 | 233 | 12,5 | M12 | |
| | F | 3020 | 75 | 63,5 | 51 | - | - | | 134 | | | | |
| | H | 3020 | 75 | 63,5 | 51 | - | - | | 134 | | | | |
| 120 | B | - | 100 | - | - | 84,5 | 70 | 314 | 143 | 264 | 14,5 | M16 | |
| | F | 3525 | 100 | 79,5 | 65 | - | - | | 140 | | | | |
| | H | 3020 | 75 | 65,5 | 51 | - | - | | 140 | | | | |
| 140 | B | - | 130 | - | - | 110,5 | 94 | 359 | 178 | 311 | 16 | M20 | |
| | F | 3525 | 100 | 81,5 | 65 | - | - | | | | | | - |
| | H | 3525 | 100 | 81,5 | 65 | - | - | | | | | | - |
| 160 | B | - | 110 | - | - | 117 | 102 | 402 | 187 | 345 | 15 | M20 | |
| | F | 4030 | 115 | 92 | 77 | - | - | | | | | | - |
| | H | 4030 | 115 | 92 | 77 | - | - | | | | | | - |
| 180 | B | - | 150 | - | - | 137 | 114 | 470 | 200 | 398 | 23 | M20 | |
| | F | 4535 | 125 | 112 | 89 | - | - | | 205 | | | | |
| | H | 4535 | 125 | 112 | 89 | - | - | | 205 | | | | |
| 200 | B | - | 150 | - | - | 138 | 114 | 508 | 200 | 429 | 24 | M20 | |
| | F | 4535 | 125 | 113 | 89 | - | - | | 205 | | | | |
| | H | 4535 | 125 | 113 | 89 | - | - | | 205 | | | | |
| 220 | B | - | 160 | - | - | 154,5 | 127 | 562 | 218 | 474 | 27,5 | M20 | |
| | F | 5040 | 125 | 129,5 | 102 | - | - | | 223 | | | | |
| | H | 5040 | 125 | 129,5 | 102 | - | - | | 223 | | | | |
| 250 | B | - | 190 | - | - | 154,5 | 132 | 628 | 125 | 532 | 29 | M20 | |

Grootte 40 tot 60

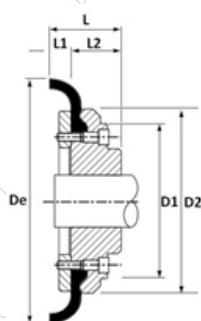

Voorgeboorde flens type B

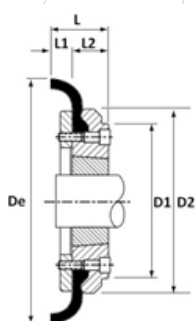

TL Flens type F voor montage langs de binnenkant

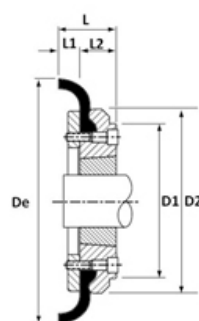

TL Flens type H voor montage langs de buitenkant

Grootte 70 tot 250

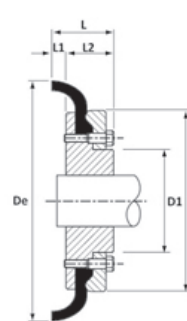

Voorgeboorde flens type B

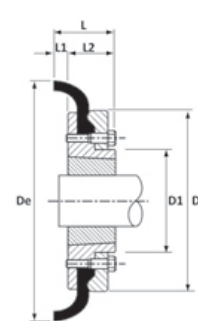

TL Flens type F voor montage langs de binnenkant

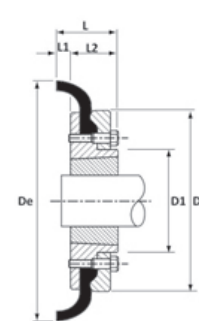

TL Flens type H voor montage langs de buitenkant

De opgegeven afmetingen kunnen zonder voorafgaande aankondiging gewijzigd worden

VERMEIRE TRANSMISSIONS SA
Rue de la Filature, 41
B-4800 ENSIVAL (VERVIERS)
T +32 (0)87 32 23 60
F +32 (0)87 31 50 71

VERMEIRE AANDRIJVINGEN NV
Traktaartweg 17
B-9050 GENT
T +32 (0)9 222 57 61
F +32 (0)9 221 72 41

www.vermeire.com

