

ANELLI ROTANTI SERIE AR

INDEXING RINGS AR SERIES



autorotor

I NOSTRI AGENTI IN ITALIA OUR AGENTS IN ITALY

Province di Bergamo, Brescia, Pavia, Cremona e Mantova	A I DI COLPANI ANNIBALE & C S. A. S. Via A. Manzoni, 29/31 - 24053 Brignano Gera d'Adda (BG) Tel. e Fax 0363 45 026 e-mail: annibale.colpani@gmail.com
Province di Como, Lecco, Novara, Sondrio, Varese, Verbania	BIANCHINI D. & C. S.A.S. Via Novellina, 14/C - 21050 Besano (VA) Tel. 0332 916 627 - Fax 0332 1642150 e-mail: info@agbianchini.com http://www.bianchinisas.com
Toscana e Umbria	UTR S.R.L. Sede legale: Via Fiorentina, 8 - 59100 Prato Sede operativa: Via Enrico Fermi, 1 - 51031 Agliana (PT) Tel. 0574 636677 / 634005 - Fax 0574 634005 e-mail: utr@utr.191.it www.utrsrl.191.it
Campania	DELVA S.R.L. SS 265 Km 25.850 - 81020 San Marco Evangelista (CE) Tel. 0823/202041 - Fax. 0823/202054 e-mail: info@delva.it web: http://www.delva.it
Puglia e Basilicata	GIUSEPPE GENGA – RAPPRESENTANZE INDUSTRIALI Via V. Bottego, 31 – 70019 Triggiano (BA) Tel. 348 3809743 – Fax 080 4685878 e-mail: giuseppe.genga@gmail.com
Province di Lodi, Milano e Monza- Brianza	RICOTTI FRANCO ANDREA Via del Futurismo, 31 – 20128 Milano (MI) Tel. e Fax 02/512261 e-mail: francoandrea.ricotti@gmail.com
Province di Piacenza, Parma, Reggio Emilia, Modena, Bologna e Ferrara	BI SYSTEM / UTR S.r.l. Via Raibolini 29/6 – 40069 Zola Pedrosa (BO) Tel. e Fax 051 250725 Cell: 348 2469851 e-mail: borsarigiancarlo@gmail.com www.bi-system.it
Marche, Abruzzo, Molise, San Marino e le Province di Forlì- Cesena, Rimini e Ravenna	WIDE AUTOMATION Via Malpasso, 1340 – 48742 San Giovanni in Marignano (RN) Tel. 0541 827200 - Fax 0541 825021 e-mail: info@wideautomation.it http://www.wideautomation.it
Province di Aosta, Alessandria, Asti, Biella, Cuneo, Torino, Vercelli, Genova, Imperia, La Spezia, Savona	SFERA RAPPRESENTANZE S.A.S. DI GHIRELLO FRANCESCO Via Devesi, 26 - 10076 Nole (TO) Tel. 011 929 6779 - Fax 011 929 5188 e-mail: info@sferarappresentanze.com
Triveneto	SIN.TEC. DI P.I. ERMANNO SANTON Via O. Galante, 79/2 - 35129 Padova Tel. 049 775 147 - Fax 049 780 62 69 e-mail: info@sinergietecniche.it http://www.sinergietecniche.it

ANELLI ROTANTI SERIE AR

INDEXING RINGS AR SERIES

INDICE

□ Anello rotante AR510	4
□ Anello rotante ARI800	8
□ Anello rotante ARI1200	12
□ Anello rotante AR1600	16
□ Anello rotante AR2100	20
□ Tempi di spostamento	24
□ Posizione di montaggio unità Motrice	25
□ Note	26

CONTENTS

□ Indexing rings AR510	4
□ Indexing rings ARI800	8
□ Indexing rings ARI1200	12
□ Indexing rings AR1600	16
□ Indexing rings AR2100	20
□ Index time	24
□ Power drive unit assembling position	25
□ Notes	26

PROPRIETA' LETTERARIA RISERVATA

ALL RIGHTS RESERVED

E' vietata la riproduzione anche parziale del testo e delle illustrazioni contenute nella presente pubblicazione

No part of this publication may be reproduced, stored in a retrieval system, or transmitted in any form without the prior permission of AUTOROTOR

Stazioni Stations	Angoli di camma Cam angles									
	90	120	150	180	210	240	270	300	330	345
2										
4										
6										
8										
12										
16										
24										



ANGOLI DI CAMMA REALIZZABILI
Feasible cam transfer angles

TOLLERANZE ANELLI ROTANTI

TOLERANCES OF INDEXING RINGS

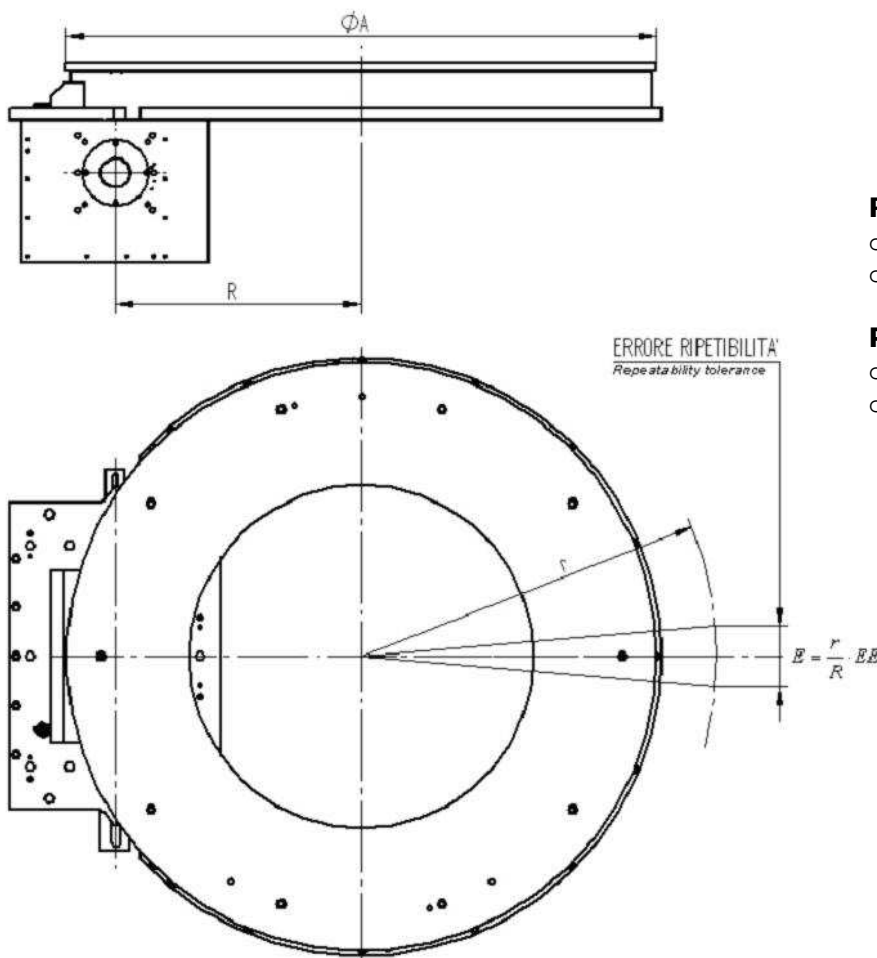

Ripetibilità / Repeatability:

- **R** : 182.5 mm
- **EE**: ± 0.015 mm

Planarità disco / Disc flatness:

- **A**: 510 mm
- **Total**: 0.03 mm

MASSIMO MOMENTO TORCENTE

MAX OUTPUT TORQUE

n° Divisioni Index no. (S)	Angolo camma Cam angle	Pausa Dwell (Mp) (da Nm)	Momento torcente uscita (da Nm) (Mu)				Legge di moto Motion law		
			Output torque capacity (daNm)				Vel. Speed Cv	Acc. Acc. Ca	Tras. Tran. K
			Cicli/min - Cycles/min.						
			25	50	75	100			
2	345	630,7	259,8	258,2	255,6		1,760	5,528	0,515
4	180	630,7	268,8	265,9	261,2		1,760	5,528	0,494
	270	630,7	365,3	364,0	361,9	359,0	1,760	5,528	0,329
	300	630,7	390,8	389,8	388,1	385,7	1,760	5,528	0,296
	330	630,7	413,4	412,6	411,1	409,2	1,760	5,528	0,269
6	120	630,7	268,3	263,9	256,6		1,760	5,528	0,494
	180	630,7	365,1	363,2	359,9		1,760	5,528	0,329
	270	630,7	459,1	458,2	456,8	454,7	1,760	5,528	0,219
	300	630,7	480,5	479,8	478,6	477,0	1,760	5,528	0,197
	330	630,7	498,4	497,8	496,9	495,5	1,760	5,528	0,179
8	120	630,7	336,1	332,9	327,6		1,760	5,528	0,370
	180	630,7	433,2	431,7	429,4		1,760	5,528	0,247
	270	630,7	513,4	512,8	511,7	510,2	1,760	5,528	0,165
	300	630,7	529,8	529,3	528,5	527,3	1,760	5,528	0,148
	330	630,7	543,0	542,6	541,9	540,9	1,760	5,528	0,135
12	120	630,7	432,9	430,7	427,1		1,760	5,528	0,247
	180	630,7	513,3	512,3	510,7		1,760	5,528	0,165
	270	630,7	566,3	565,9	565,2	564,2	1,760	5,528	0,110
	300	630,7	575,9	575,5	574,9	574,1	1,760	5,528	0,099
	330	630,7	583,3	583,0	582,5	581,8	1,760	5,528	0,090
16	120	309,0	492,5	490,8	488,0		1,760	5,528	0,185
	180	309,0	553,6	552,9	551,7		1,760	5,528	0,123
	270	309,0	589,0	588,7	588,2	587,4	1,760	5,528	0,082
	300	309,0	595,0	594,7	594,3	593,7	1,760	5,528	0,074
	330	309,0	599,6	599,3	599,0	598,4	1,760	5,528	0,067
24	120	309,0	267,0	265,9	264,1		1,760	5,528	0,123
	180	309,0	284,4	284,0	283,2		1,760	5,528	0,082
	270	309,0	293,3	293,1	292,8	292,3	1,760	5,528	0,055
	300	309,0	294,7	294,6	294,3	293,9	1,760	5,528	0,049
	330	309,0	295,8	295,7	295,4	295,1	1,760	5,528	0,045

CARICHI APPLICABILI

MAX LOADS

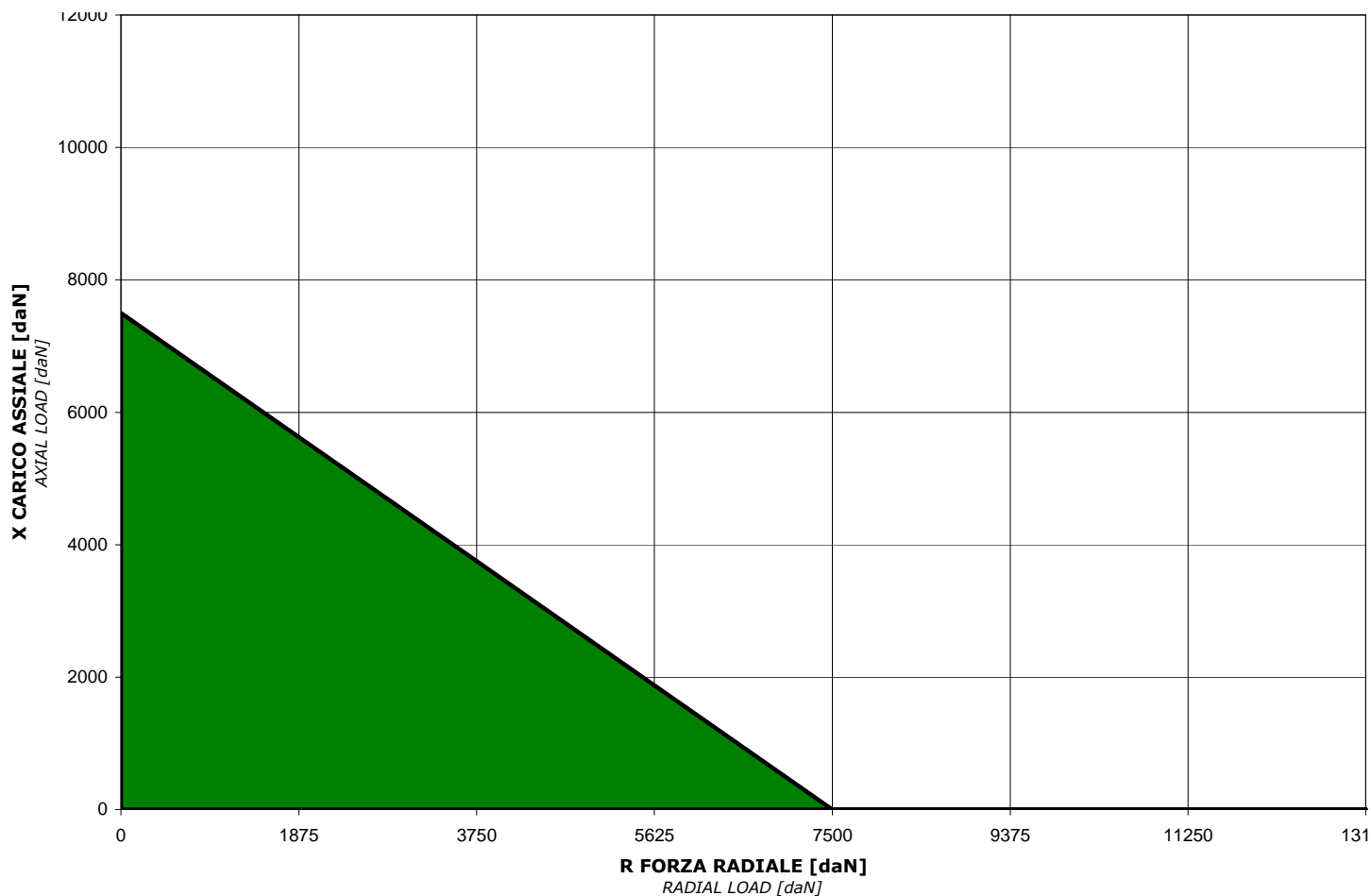

Carico assiale statico <i>Static axial load</i>	Carico radiale statico <i>Static radial load</i>	Momento ribaltante statico <i>Static overturning torque</i>
daN		daNm
7500	7500	720

FORI PER ASSEMBLAGGIO SU DISCO ROTANTE

ASSEMBLING THREADED HOLES ON ROTATING DISK

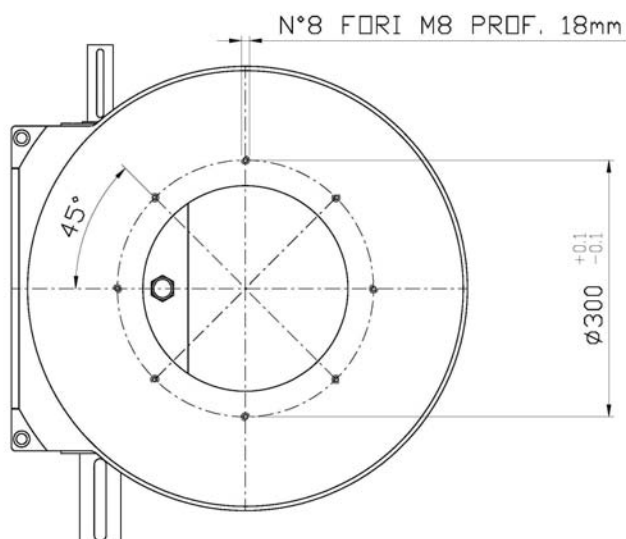

ANELLO ROTANTE ROTARY INDEX RING AR510

PESO / Weight Kg.220

DISPONIBILE SU DISCO CAD
Available on CAD disc

FILE
W42018

 ROTANTE
ROTATING

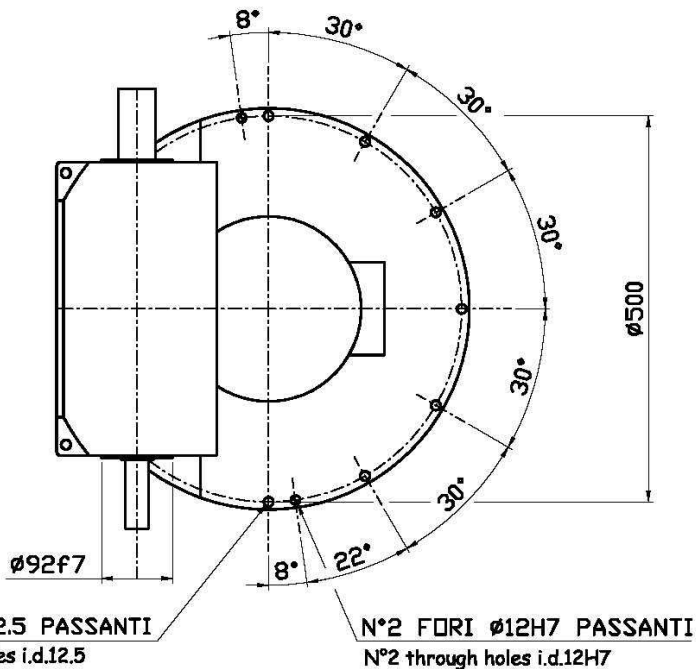

IL DISCO ROTANTE 510 X 18 VIENE
FORNITO SU SPECIFICA RICHIESTA

the ring disc 510 x 18 is
supplied only when required

N°4 FORI M10 PROF.=24 ANCHE SU PIANO A
N°4 M10 holes depth=24 on plane A too

N°4 FORI M8 PROF.=20 ANCHE SU PIANO A
N°4 M8 holes depth=20 on plane A too

N°2 FORI $\phi 10H7$ prof.=20 ANCHE SU PIANO A
N°2 holes i.d. 10H7 depth=20 on plane A too

PIANO A
Plane A

N°2 SEDI VITE M12
N°2 seats for screw M12

PREGO CONSULTARE UFF. TECNICO PER STABILIRE
FORATURA PIU' ADATTA PER MONTAGGIO DISCO ROTANTE
please contact our technical dept to decide on the
suitable holes to match the (rotating) disk

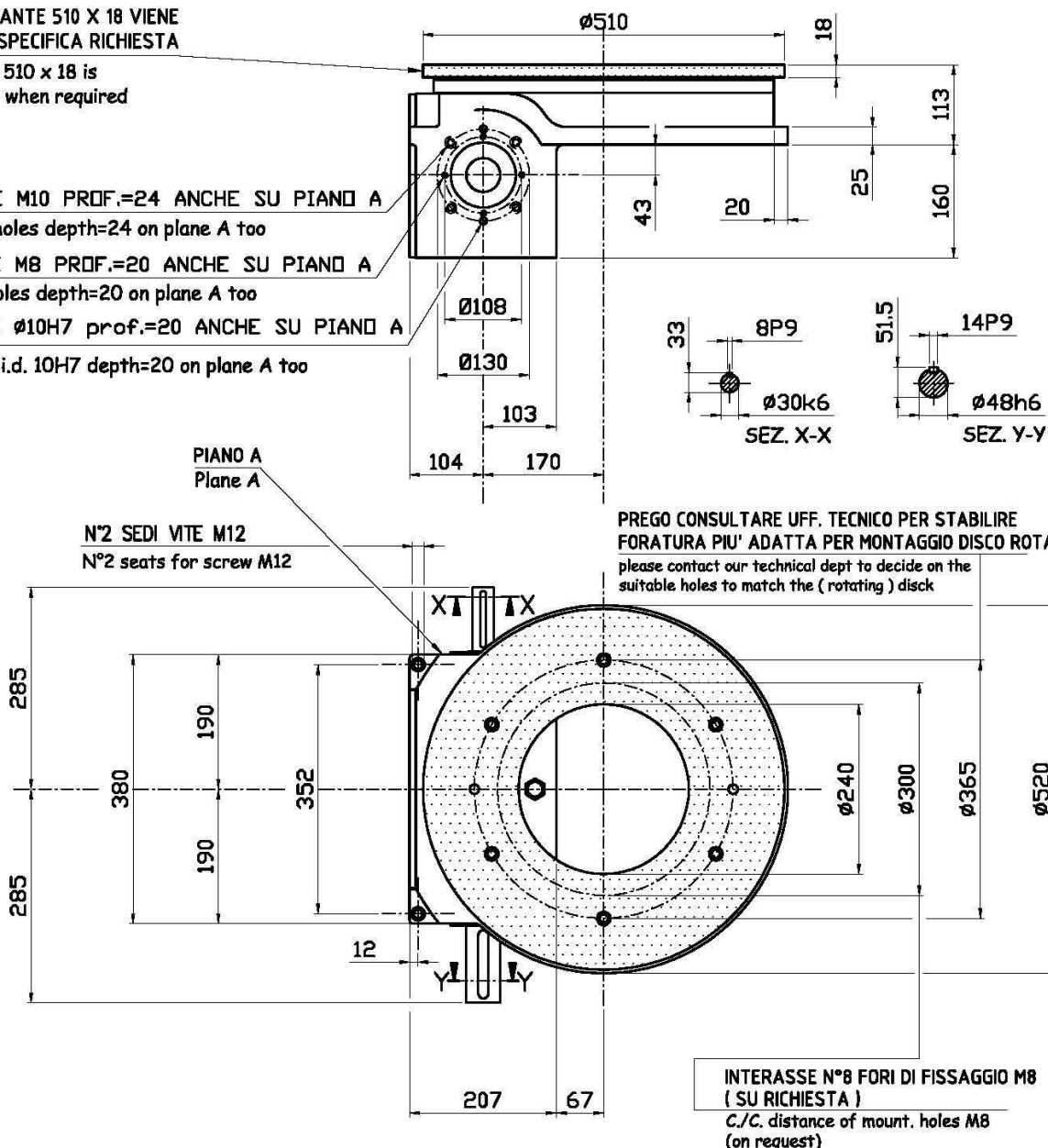

INTERASSE N°8 FORI DI FISSAGGIO M8
(SU RICHIESTA)
C./C. distance of mount. holes M8
(on request)

Stazioni Stations	Angoli di camma Cam angles									
	90	120	150	180	210	240	270	300	330	345
2										
4										
6										
8										
12										
16										
24										



ANGOLI DI CAMMA REALIZZABILI
Feasible cam transfer angles

TOLLERANZE ANELLI ROTANTI

TOLERANCES OF INDEXING RINGS

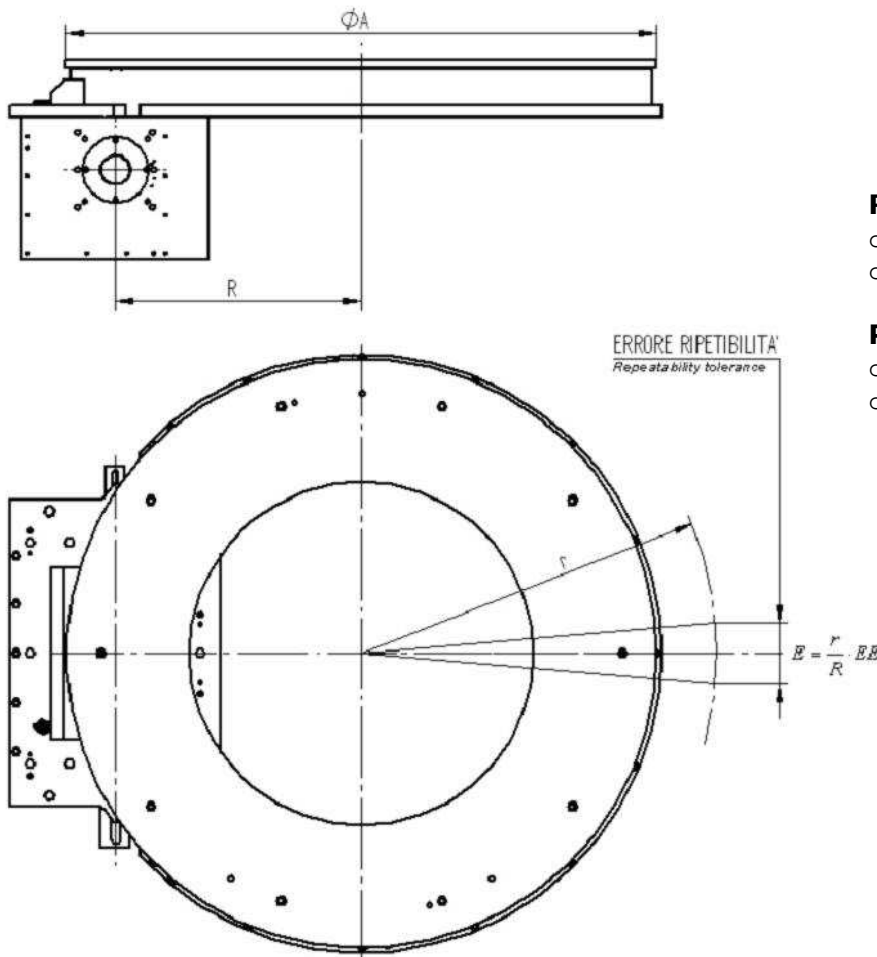

Ripetibilità / Repeatability:

- **R** : 310 mm
- **EE**: ± 0.02 mm

Planarità disco / Disc flatness:

- **A**: 800 mm
- **Total**: 0.04 mm

MASSIMO MOMENTO TORCENTE

MAX OUTPUT TORQUE

n° Divisioni Index no. (S)	Angolo camma Cam angle	Pausa Dwell (Mp) (da Nm)	Momento torcente uscita (da Nm) (Mu)				Legge di moto Motion law		
			Output torque capacity (daNm)				Vel. Speed Cv	Acc. Acc. Ca	Tras. Tran. K
			Cicli/min - Cycles/min.						
			25	50	75	100			
2	345	1810,5	645,0	632,5	611,7	582,6	1,500	5,755	0,619
4	180	1071,3	387,0	371,0	344,4	307,1	1,760	5,528	0,423
	270	1071,3	481,9	472,2	456,1	433,6	1,760	5,528	0,329
	300	1071,3	524,2	516,4	503,4	485,1	1,760	5,528	0,296
	330	1071,3	563,4	556,9	546,2	531,1	1,760	5,528	0,269
6	180	1810,5	822,5	807,7	783,1	748,7	1,760	5,528	0,329
	270	1810,5	1103,6	1097,0	1086,1	1070,8	1,760	5,528	0,219
	300	1810,5	1176,2	1170,9	1162,0	1149,6	1,760	5,528	0,197
	330	1810,5	1239,9	1235,5	1228,2	1217,9	1,760	5,528	0,179
8	180	1810,5	1020,1	1008,9	990,2	964,0	1,760	5,528	0,247
	270	1810,5	1295,4	1290,4	1282,1	1270,4	1,760	5,528	0,165
	300	1810,5	1359,5	1355,4	1348,7	1339,3	1,760	5,528	0,148
	330	1810,5	1413,4	1410,0	1404,5	1396,7	1,760	5,528	0,135
12	120	1810,5	1018,3	1001,7	974,1	935,3	1,760	5,528	0,247
	180	1810,5	1294,6	1287,2	1274,9	1257,7	1,760	5,528	0,165
	270	1810,5	1514,2	1510,9	1505,5	1497,8	1,760	5,528	0,110
	300	1810,5	1558,2	1555,5	1551,1	1544,9	1,760	5,528	0,099
	330	1810,5	1593,2	1591,0	1587,4	1582,3	1,760	5,528	0,090
16	120	1810,5	1216,9	1204,3	1183,3	1153,8	1,760	5,528	0,185
	180	1810,5	1458,0	1452,4	1443,0	1429,9	1,760	5,528	0,123
	270	1810,5	1621,3	1618,8	1614,7	1608,8	1,760	5,528	0,082
	300	1810,5	1651,2	1649,1	1645,8	1641,1	1,760	5,528	0,074
	330	1810,5	1674,3	1672,7	1669,9	1666,0	1,760	5,528	0,067
24	120	1071,3	856,5	848,2	834,3	814,8	1,760	5,528	0,123
	180	1071,3	954,1	950,4	944,2	935,6	1,760	5,528	0,082
	270	1071,3	1009,1	1007,4	1004,7	1000,8	1,760	5,528	0,055
	300	1071,3	1018,2	1016,9	1014,7	1011,6	1,760	5,528	0,049
	330	1071,3	1025,2	1024,1	1022,3	1019,7	1,760	5,528	0,045

CARICHI APPLICABILI

MAX LOADS

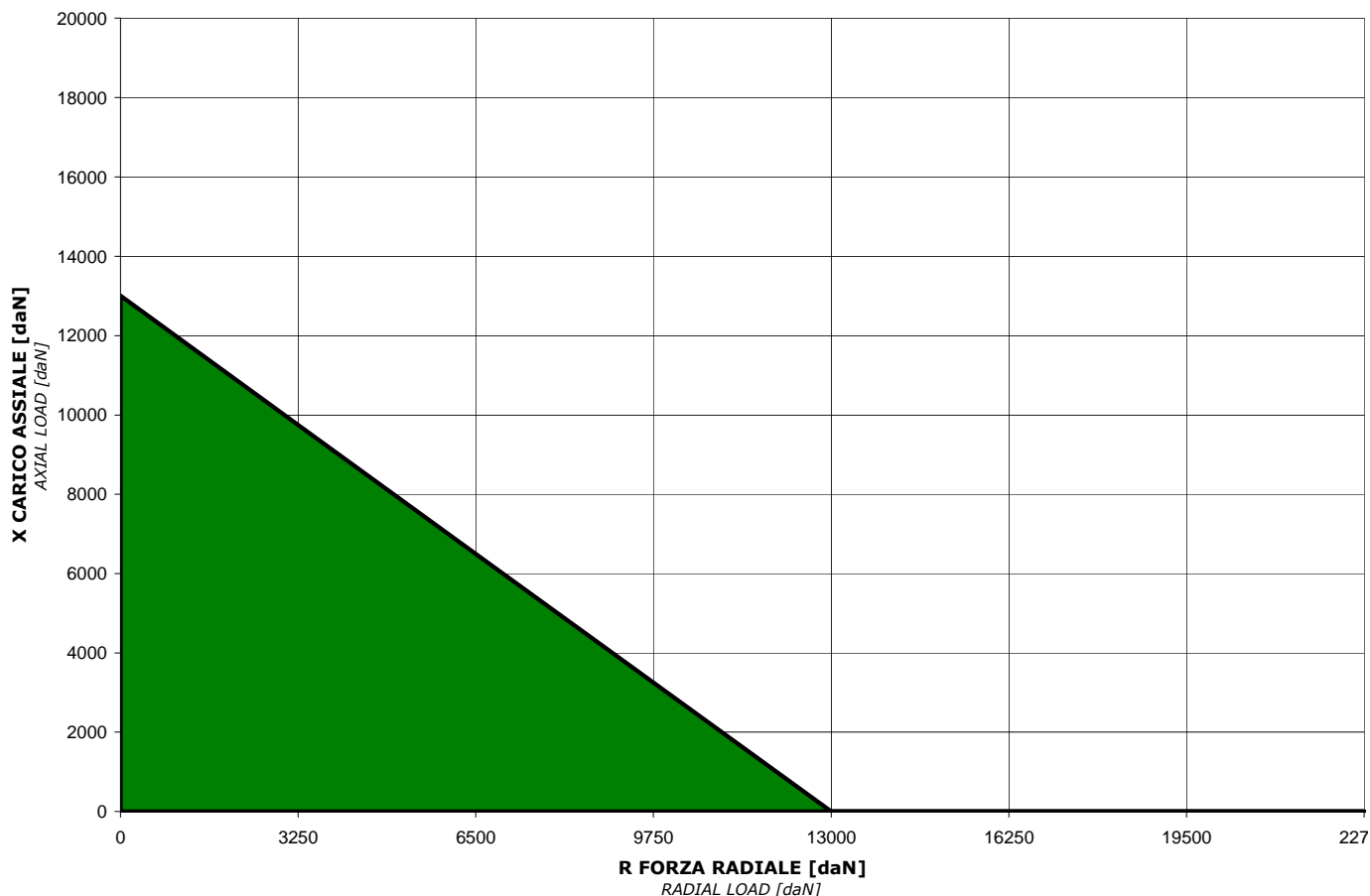

Carico assiale statico <i>Static axial load</i>	Carico radiale statico <i>Static radial load</i>	Momento ribaltante statico <i>Static overturning torque</i>
daN		daNm
13000	13000	1760

FORI PER L'ASSEMBLAGGIO SU DISCO ROTANTE

ASSEMBLING THREADED HOLES ON ROTATING DISK

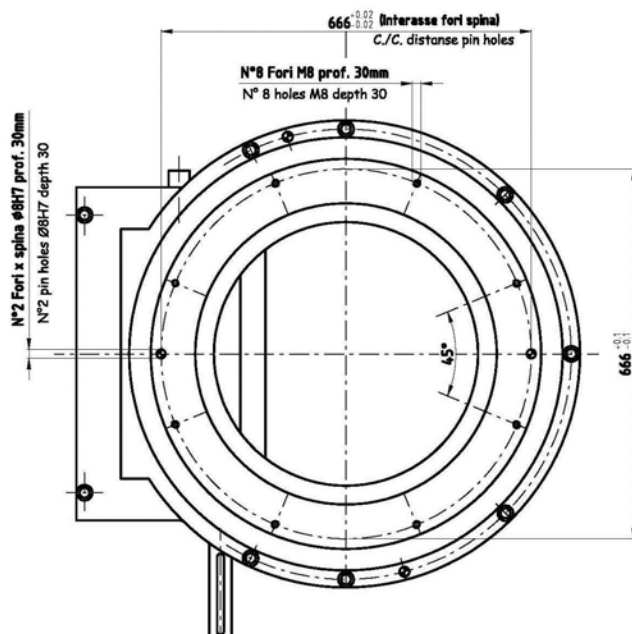

ANELLO ROTANTE
ROTARY INDEX RING
ARI 800

PESO / Weight Kg. 350

FILE W42909

 ROTANTE
 ROTATING

N°8 Fori M8 prof.=20
 N°8 M8 holes depth=20

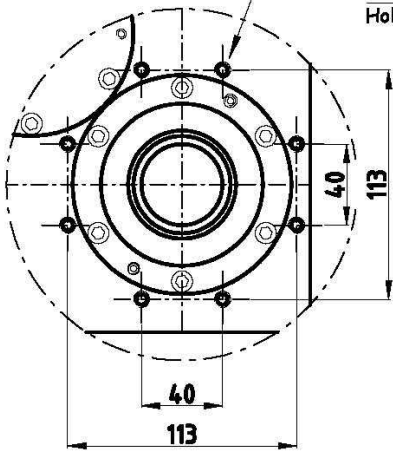

DETTAGLIO -A-
 PARTICULAR -A-

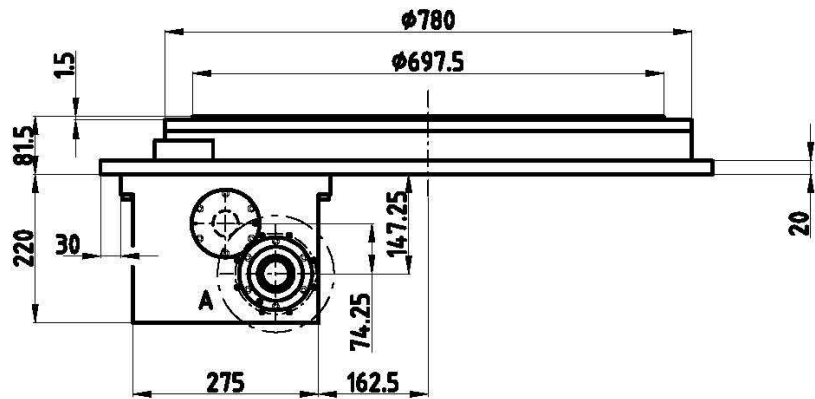
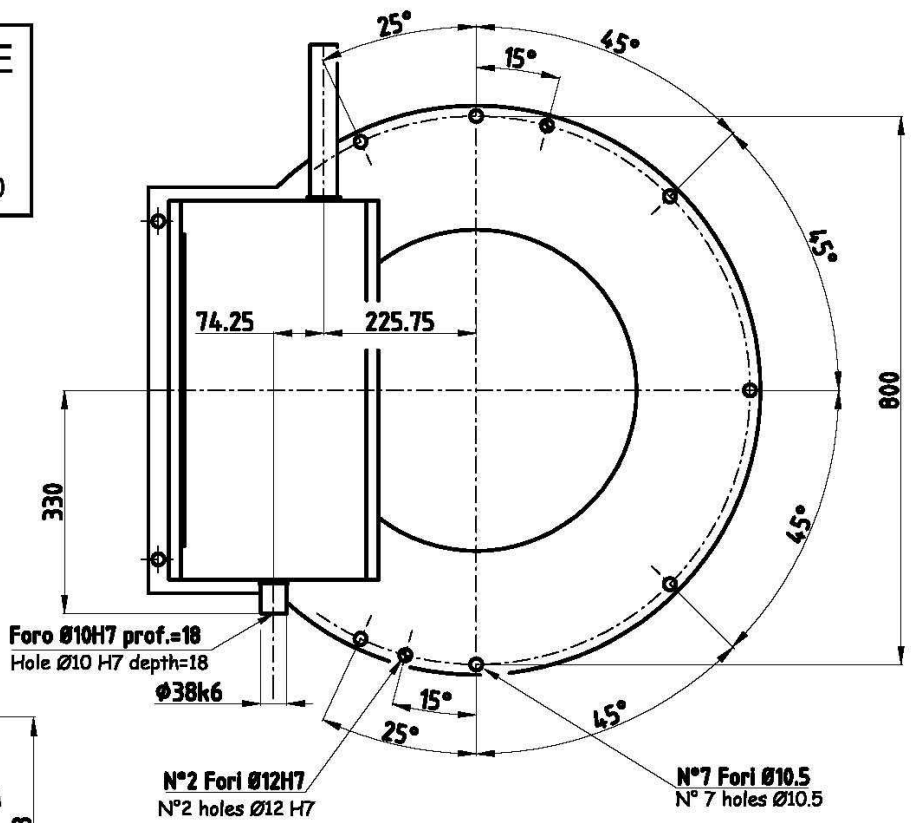

N°2 sedi per vite M10
 N°2 seats for scrw M10

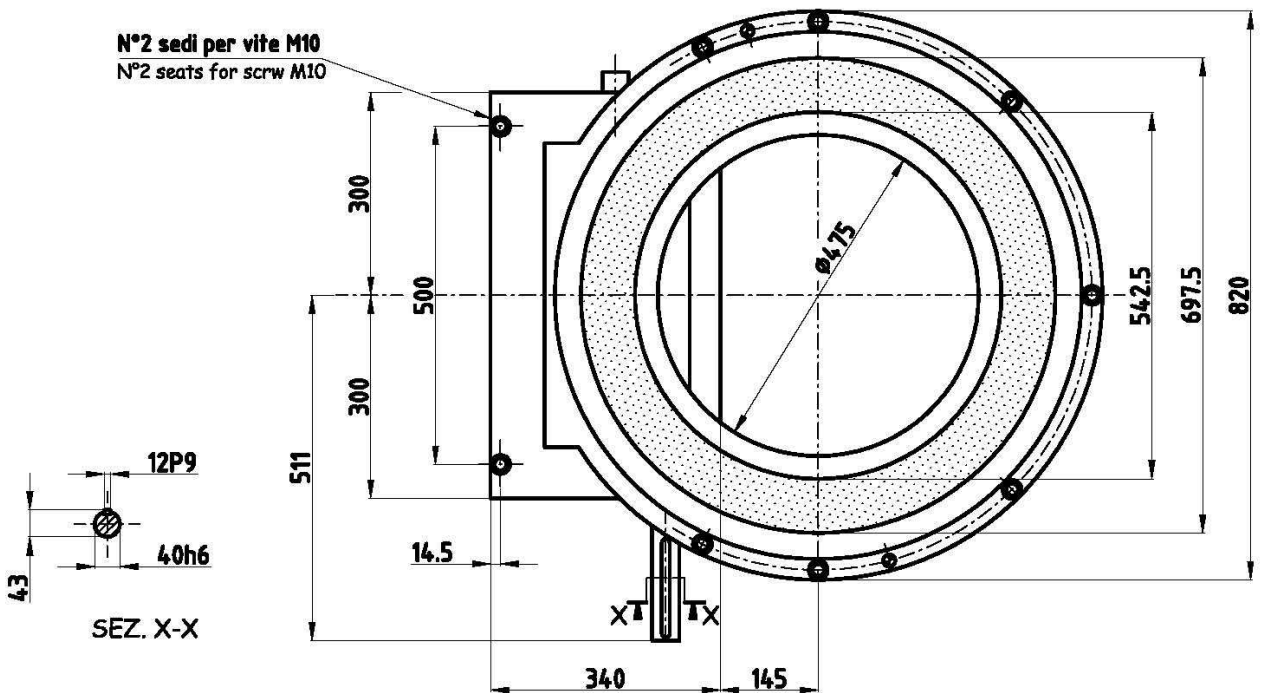

Stazioni Stations	Angoli di camma Cam angles									
	90	120	150	180	210	240	270	300	330	345
2										
4										
6										
8										
12										
16										
24										



ANGOLI DI CAMMA REALIZZABILI
Feasible cam transfer angles

TOLLERANZE ANELLI ROTANTI

TOLERANCES OF INDEXING RINGS

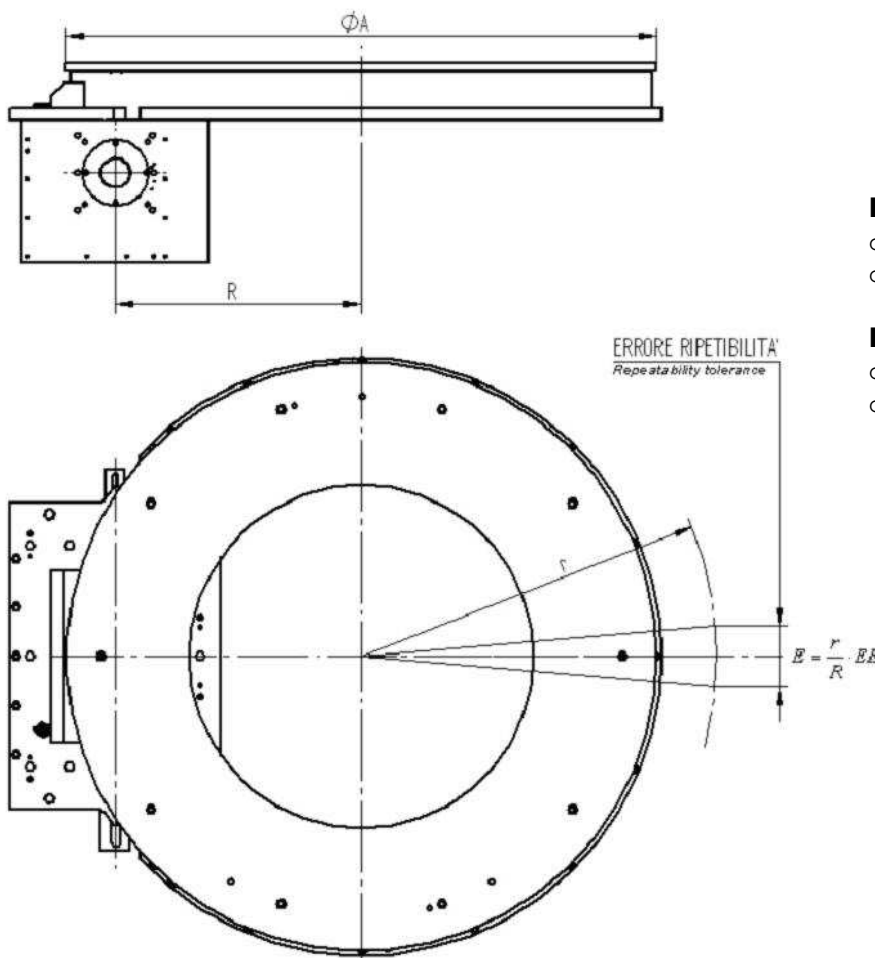

Ripetibilità / Repeatability:

- **R** : 500 mm
- **EE**: ± 0.03 mm

Planarità disco / Disc flatness:

- **A**: 1200 mm
- **Total**: 0.05 mm

MASSIMO MOMENTO TORCENTE

MAX OUTPUT TORQUE

n° Divisioni Index no. (S)	Angolo camma Cam angle	Pausa Dwell (Mp) (da Nm)	Momento torcente uscita (da Nm) (Mu)				Legge di moto Motion law		
			Output torque capacity (daNm)				Vel. Speed Cv	Acc. Acc. Ca	Tras. Tran. K
			Cicli/min - Cycles/min.						
			25	50	75	100			
2	345								
4	180								
	270								
	300								
	330								
6	120								
	180	2978,5	867,7	805,3	701,2	555,5	1,760	5,528	0,329
	270	2978,5	1258,7	1231,0	1184,7	1120,0	1,760	5,528	0,219
	300	2978,5	1372,9	1350,4	1313,0	1260,5	1,760	5,528	0,197
	330	2978,5	1479,5	1460,9	1430,0	1386,6	1,760	5,528	0,179
8	180	2978,5	1132,9	1086,2	1008,5	899,7	1,760	5,528	0,247
	270	2978,5	1577,0	1556,3	1521,8	1473,4	1,760	5,528	0,165
	300	2978,5	1698,8	1682,1	1654,1	1614,9	1,760	5,528	0,148
	330	2978,5	1808,9	1795,0	1771,9	1739,5	1,760	5,528	0,135
12	180	2978,5	1573,7	1542,9	1491,5	1419,6	1,760	5,528	0,165
	270	2978,5	2037,0	2023,3	2000,5	1968,5	1,760	5,528	0,110
	300	2978,5	2148,5	2137,4	2118,9	2093,1	1,760	5,528	0,099
	330	2978,5	2243,6	2234,4	2219,2	2197,8	1,760	5,528	0,090
16	150	2978,5	1693,2	1659,7	1603,7	1525,4	1,760	5,528	0,148
	180	2978,5	1904,2	1880,8	1842,0	1787,6	1,760	5,528	0,123
	270	2978,5	2323,9	2313,6	2296,3	2272,1	1,760	5,528	0,082
	300	2978,5	2414,6	2406,2	2392,2	2372,6	1,760	5,528	0,074
	330	2978,5	2488,8	2481,8	2470,3	2454,1	1,760	5,528	0,067
24	150	2978,5	2144,6	2121,9	2083,9	2030,8	1,760	5,528	0,099
	180	2978,5	2322,1	2306,3	2279,9	2243,0	1,760	5,528	0,082
	270	2978,5	2622,1	2615,0	2603,3	2586,9	1,760	5,528	0,055
	300	2978,5	2678,3	2672,6	2663,1	2649,9	1,760	5,528	0,049
	330	2978,5	2722,3	2717,6	2709,8	2698,8	1,760	5,528	0,045

CARICHI APPLICABILI

MAX LOADS

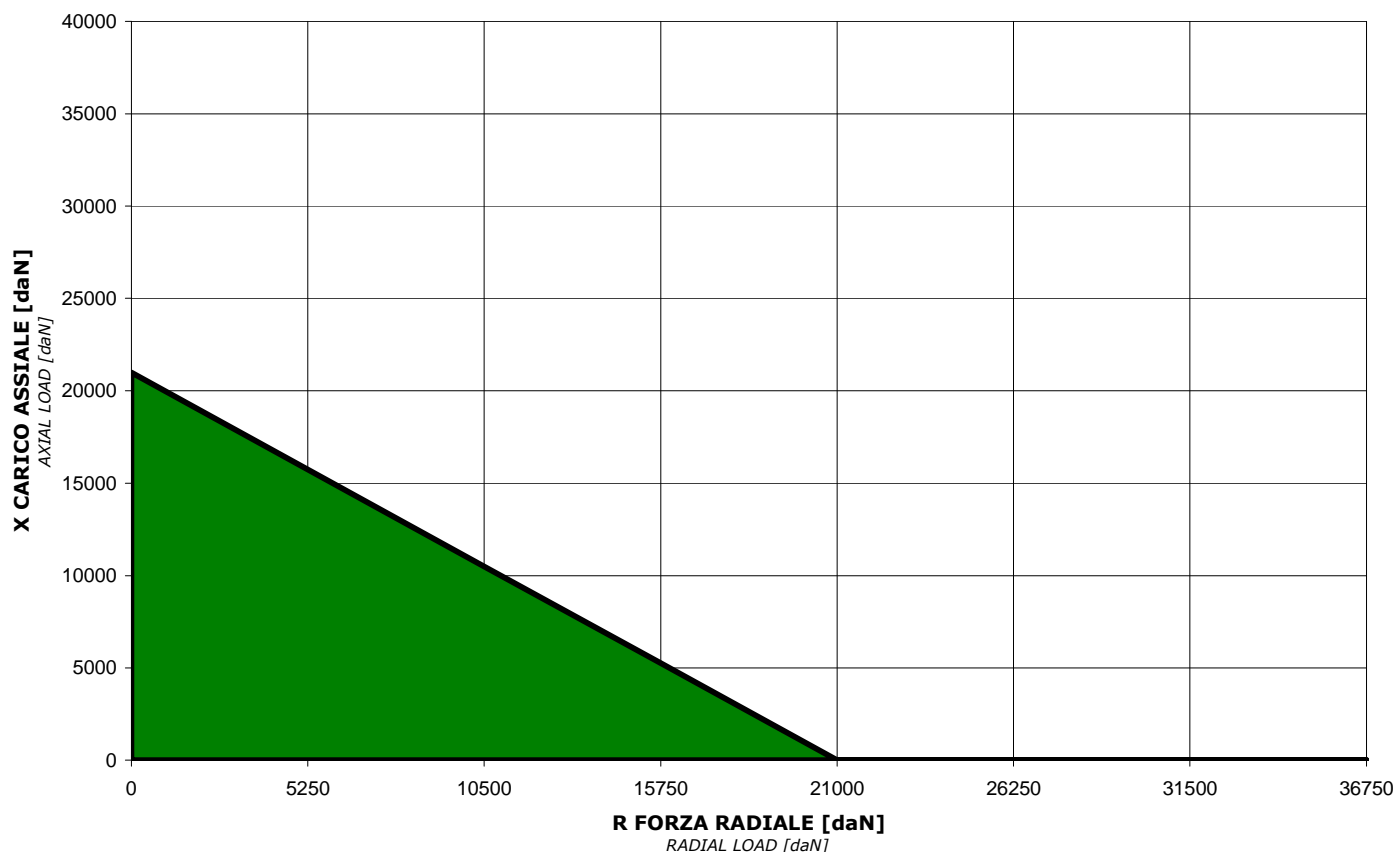

Carico assiale statico <i>Static axial load</i>	Carico radiale statico <i>Static radial load</i>	Momento ribaltante statico <i>Static overturning torque</i>
daN		daNm
21000	21000	3500

FORI PER L'ASSEMBLAGGIO DEL DISCO ROTANTE

ASSEMBLING THREADED HOLES FOR ROTATING DISK

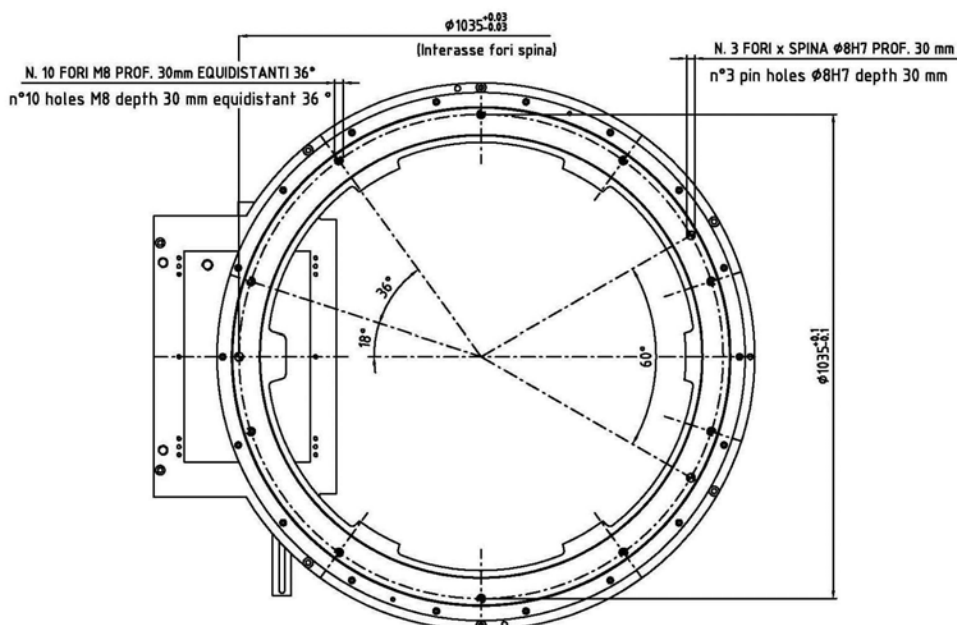

ANELLO ROTANTE
ROTARY INDEX RING
ARI 1200

PESO / Weight **Kg.400**

FILE W42823

 **ROTANTE**
ROTATING

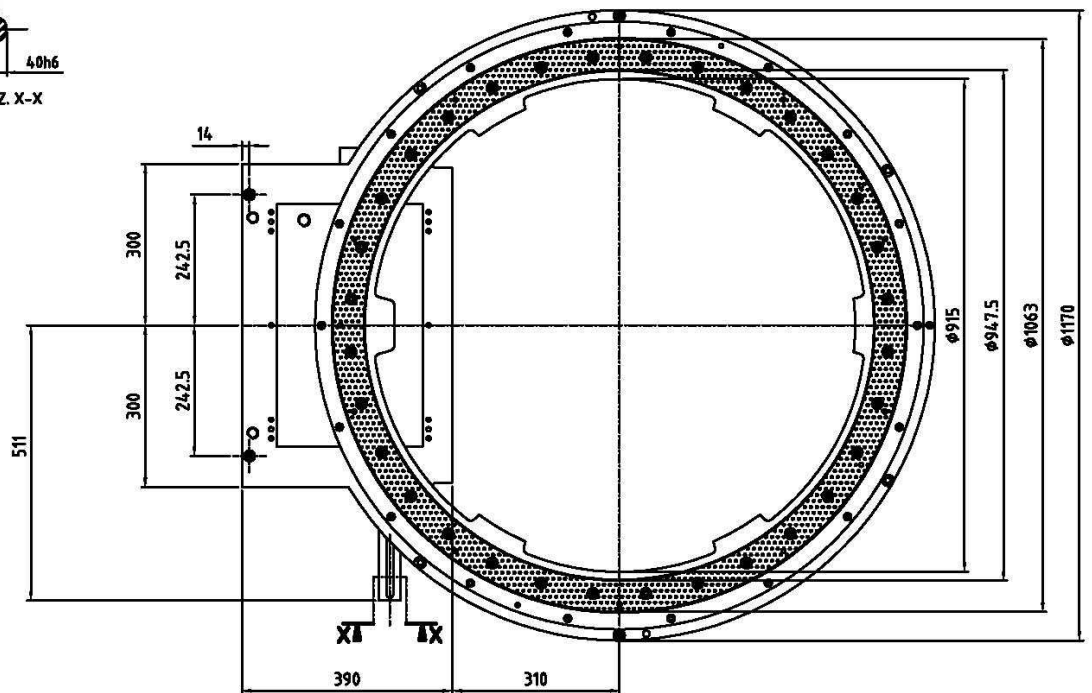
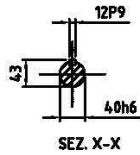
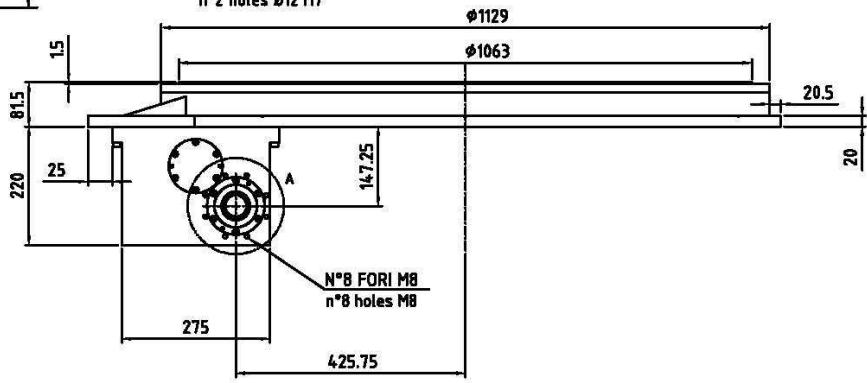
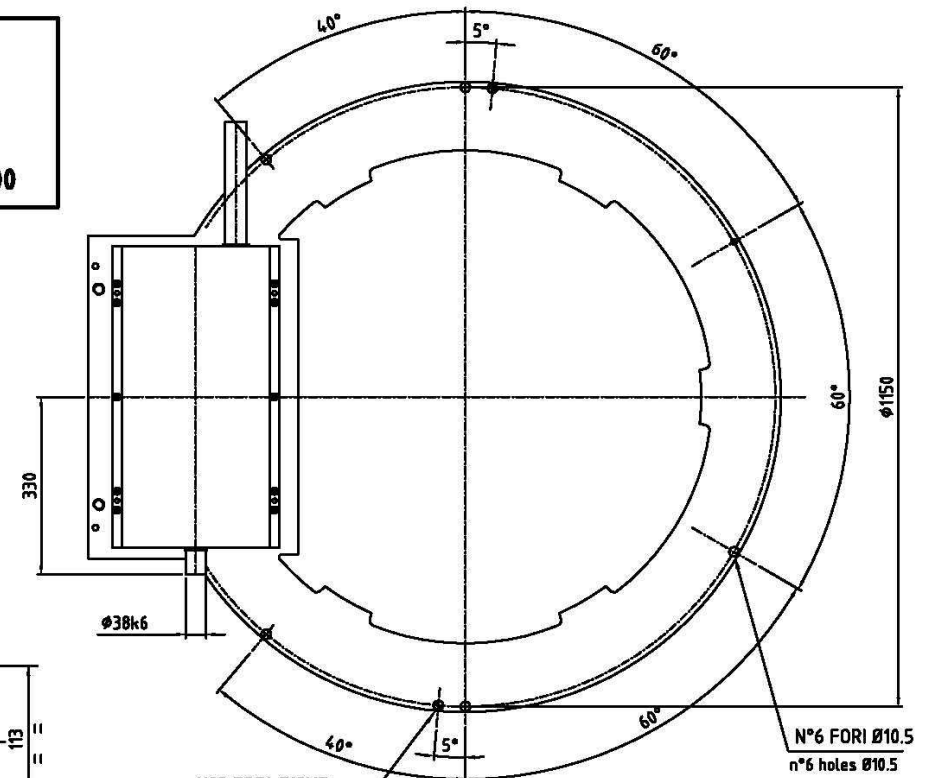
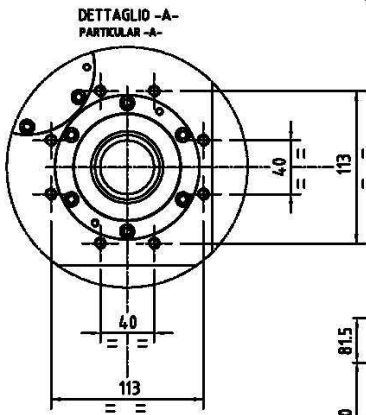

ANELLO ROTANTE

INDEXING RING

AR 1600

Stazioni Stations	Angoli di camma Cam angles									
	90	120	150	180	210	240	270	300	330	345
2										
4										
6										
8										
12										
16										
24										



ANGOLI DI CAMMA REALIZZABILI
Feasible cam transfer angles

TOLLERANZE ANELLI ROTANTI

TOLERANCES OF INDEXING RINGS

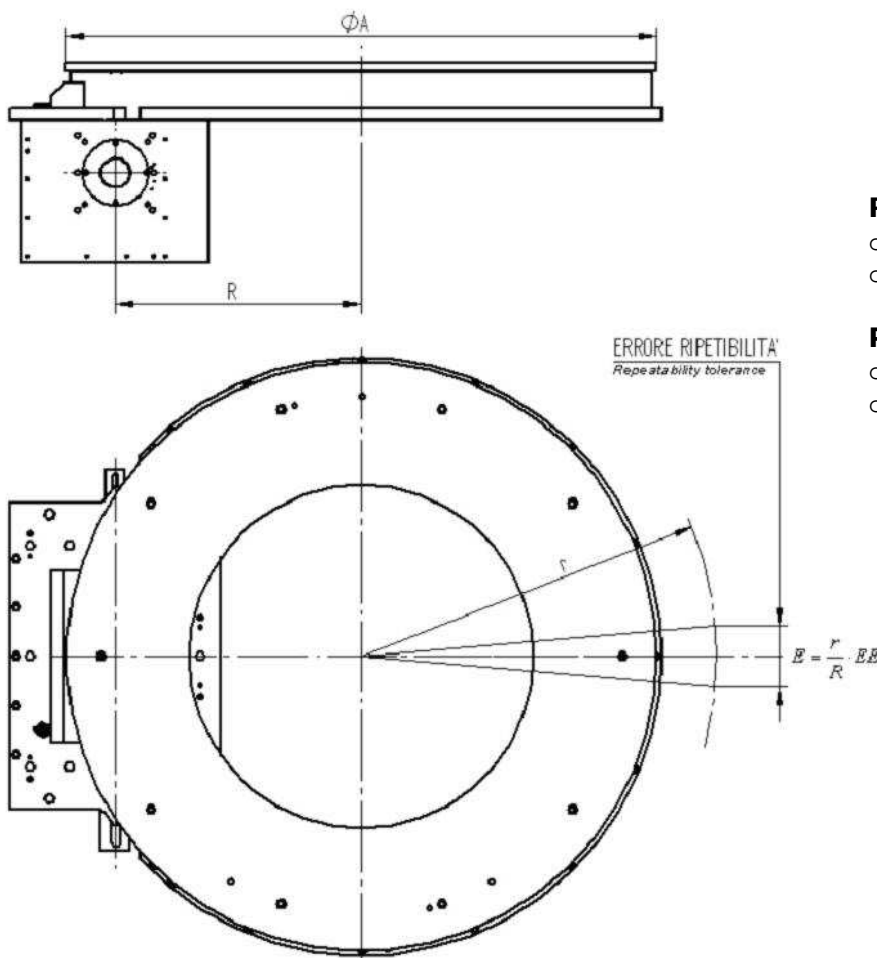

Ripetibilità / Repeatability:

- **R** : 700 mm
- **EE**: ±0.04 mm

Planarità disco / Disc flatness:

- **A**: 1600 mm
- **Total**: 0.07 mm

MASSIMO MOMENTO TORCENTE

MAX OUTPUT TORQUE

n° Divisioni Index no. (S)	Angolo camma Cam angle	Pausa Dwell (Mp) (da Nm)	Momento torcente uscita (da Nm) (Mu)				Legge di moto Motion law		
			Output torque capacity (daNm)				Vel. Speed Cv	Acc. Acc. Ca	Tras. Tran. K
			Cicli/min - Cycles/min.						
			25	50	75	100			
2	345								
4	180								
	270								
	300								
	330								
6	120								
	180								
	270								
	300								
	330								
8	120								
	180	4088,2	2027,9	1916,3	1730,3	1469,8	1,760	5,528	0,247
	270	4088,2	2680,5	2630,9	2548,2	2432,5	1,760	5,528	0,165
	300	4088,2	2840,5	2800,4	2733,4	2639,6	1,760	5,528	0,148
	330	4088,2	2978,2	2945,0	2889,7	2812,2	1,760	5,528	0,135
12	180	4088,2	2671,9	2596,5	2470,7	2294,7	1,760	5,528	0,165
	270	4088,2	3241,3	3207,7	3151,9	3073,6	1,760	5,528	0,110
	300	4088,2	3361,6	3334,5	3289,2	3225,8	1,760	5,528	0,099
	330	4088,2	3459,4	3437,0	3399,6	3347,2	1,760	5,528	0,090
16	150	4088,2	2826,4	2743,8	2606,2	2413,5	1,760	5,528	0,148
	180	4088,2	3087,0	3029,7	2934,1	2800,3	1,760	5,528	0,123
	270	4088,2	3537,4	3511,9	3469,4	3409,9	1,760	5,528	0,082
	300	4088,2	3623,6	3602,9	3568,5	3520,3	1,760	5,528	0,074
	330	4088,2	3691,3	3674,3	3645,8	3606,0	1,760	5,528	0,067
24	150	4088,2	3352,6	3298,3	3207,7	3081,0	1,760	5,528	0,099
	180	4088,2	3533,3	3495,6	3432,7	3344,7	1,760	5,528	0,082
	270	4088,2	3806,0	3789,3	3761,3	3722,2	1,760	5,528	0,055
	300	4088,2	3852,9	3839,3	3816,7	3785,0	1,760	5,528	0,049
	330	4088,2	3888,7	3877,5	3858,8	3832,6	1,760	5,528	0,045

CARICHI APPLICABILI

MAX LOADS

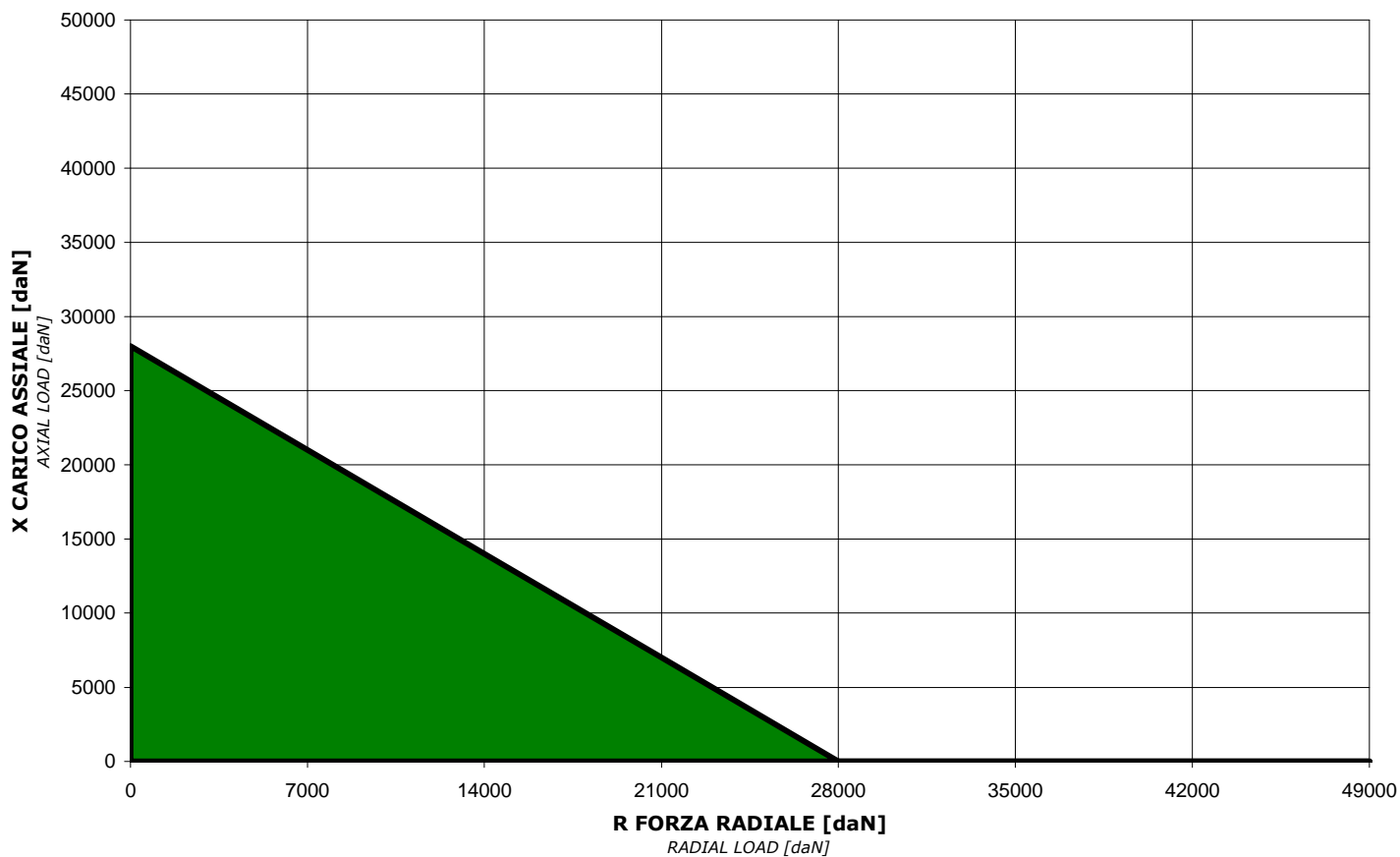

Carico assiale statico <i>Static axial load</i>	Carico radiale statico <i>Static radial load</i>	Momento ribaltante statico <i>Static overturning torque</i>
daN		daNm
28000	28000	4820

FORI PER L'ASSEMBLAGGIO SU DISCO ROTANTE

ASSEMBLING THREADED HOLES ON ROTATING DISK

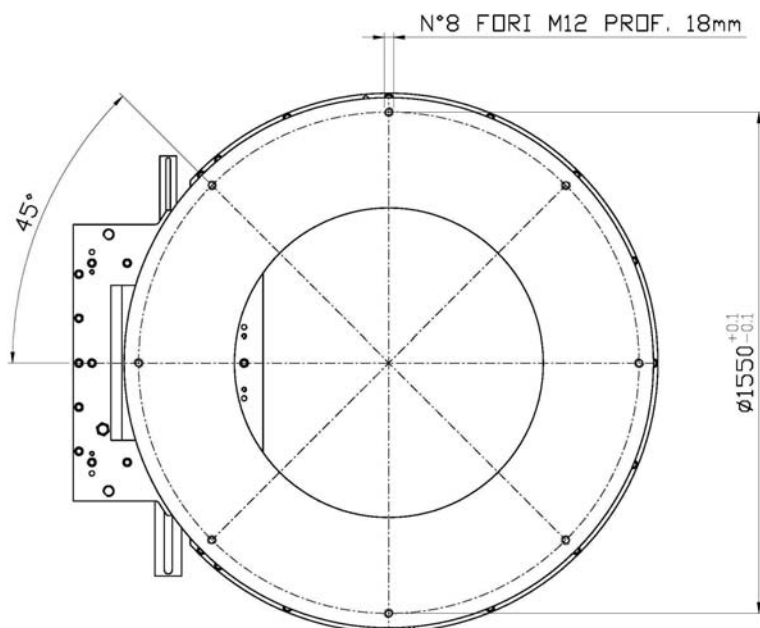

ANELLO ROTANTE ROTARY INDEX RING AR1600

PESO / Weight Kg.1100

DISPONIBILE SU DISCO CAD
Available on CAD disc

FILE
W41952

 ROTANTE
ROTATING

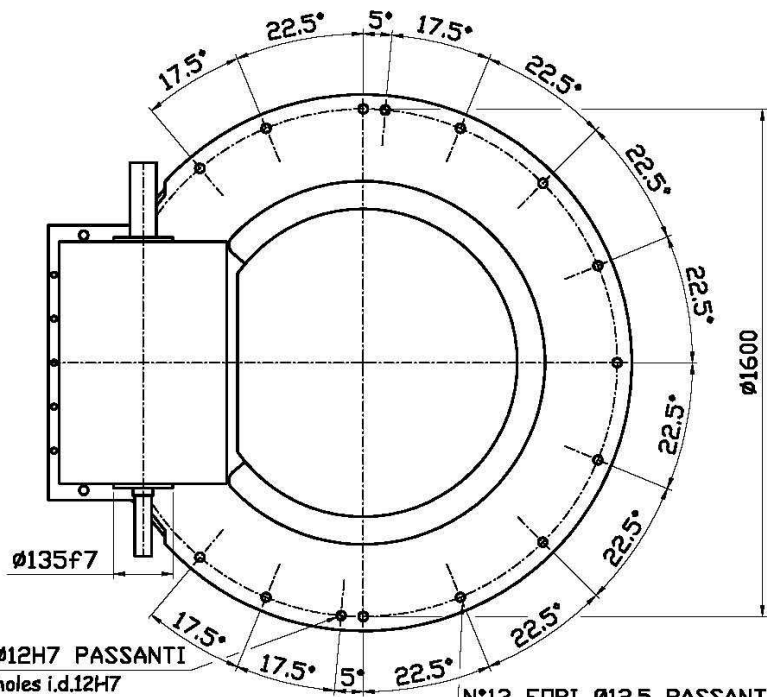

N°2 FORI Ø12H7 PASSANTI
N°2 through holes i.d.12H7

N°13 FORI Ø12.5 PASSANTI
N°13 through holes i.d.12.5

IL DISCO ROTANTE 1600 X 18 VIENE
FORNITO SU SPECIFICA RICHIESTA

the ring disc 1600 x 18 is
supplied only when required

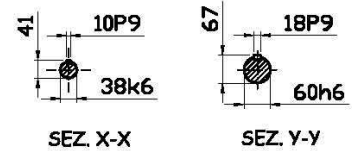
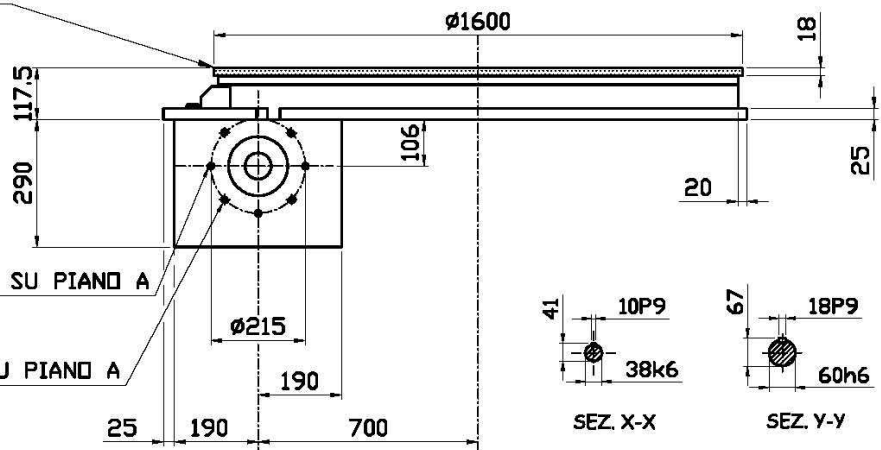

N°3 FORI Ø14H7 PROF.=20 ANCHE SU PIANO A
N°3 holes i.d. 14H7 depth=20 on plane A too

N°4 FORI M14 PROF.=30 ANCHE SU PIANO A
N°4 M14 holes depth=30 on plane A too

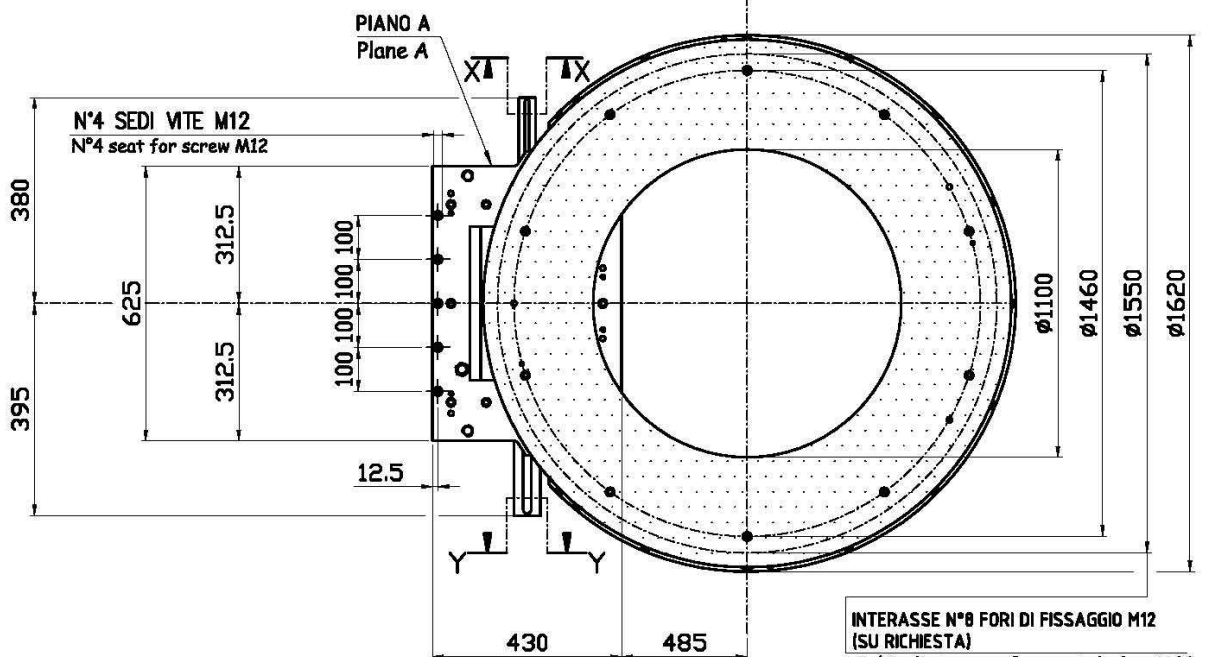

INTERASSE N°8 FORI DI FISSAGGIO M12
(SU RICHIESTA)
C./C. distance of mount. holes M12
(on request)

ANELLO ROTANTE

INDEXING RING

AR 2100

Stazioni Stations	Angoli di camma Cam angles									
	90	120	150	180	210	240	270	300	330	345
2										
4										
6										
8										
12										
16										
24										



ANGOLI DI CAMMA REALIZZABILI
Feasible cam transfer angles

TOLLERANZE ANELLI ROTANTI

TOLERANCES OF INDEXING RINGS

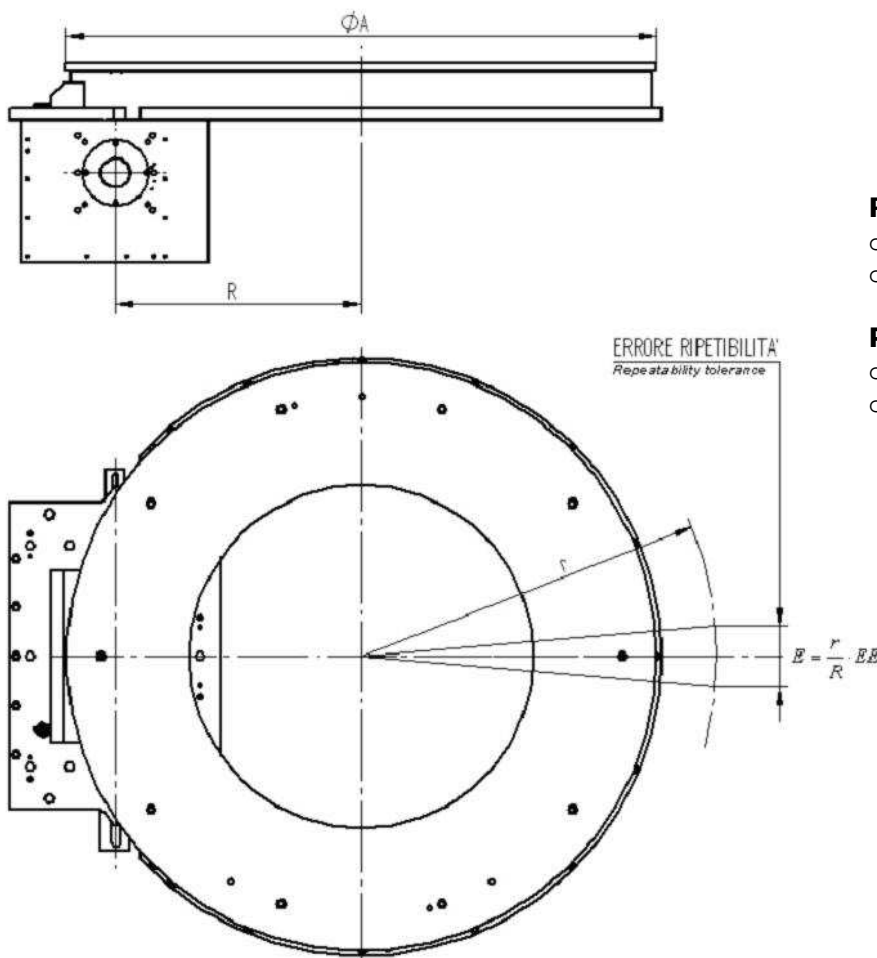

Ripetibilità / Repeatability:

- **R** : 950 mm
- **EE**: ±0.05 mm

Planarità disco / Disc flatness:

- **A**: 2100 mm
- **Total**: 0.09 mm

MASSIMO MOMENTO TORCENTE

MAX OUTPUT TORQUE

n° Divisioni Index no. (S)	Angolo camma Cam angle	Pausa Dwell (Mp) (da Nm)	Momento torcente uscita (da Nm) (Mu)				Legge di moto Motion law		
			Output torque capacity (daNm)				Vel. Speed Cv	Acc. Acc. Ca	Tras. Tran. K
			Cicli/min - Cycles/min.						
			25	50	75	100			
2	345								
4	180								
	270								
	300								
	330								
6	120								
	180								
	270								
	300								
	330								
8	120								
	180								
	270								
	300								
	330								
12	120								
	180	5548,2	2969,2	2818,8	2568,2	2217,2	1,760	5,528	0,165
	270	5548,2	3845,8	3779,0	3667,6	3511,6	1,760	5,528	0,110
	300	5548,2	4053,2	3999,0	3908,8	3782,5	1,760	5,528	0,099
	330	5548,2	4228,9	4184,2	4109,6	4005,2	1,760	5,528	0,090
16	150	5548,2	3189,3	3024,8	2750,7	2367,0	1,760	5,528	0,148
	180	5548,2	3591,0	3476,8	3286,4	3019,9	1,760	5,528	0,123
	270	5548,2	4373,9	4323,1	4238,5	4120,1	1,760	5,528	0,082
	300	5548,2	4540,4	4499,2	4430,7	4334,8	1,760	5,528	0,074
	330	5548,2	4675,9	4642,0	4585,3	4506,0	1,760	5,528	0,067
24	120	5548,2	4035,1	3926,8	3746,4	3493,7	1,760	5,528	0,099
	180	5548,2	4365,7	4290,5	4165,2	3989,8	1,760	5,528	0,082
	270	5548,2	4915,9	4882,5	4826,8	4748,8	1,760	5,528	0,055
	300	5548,2	5017,9	4990,9	4945,7	4882,6	1,760	5,528	0,049
	330	5548,2	5097,5	5075,1	5037,8	4985,6	1,760	5,528	0,045

CARICHI APPLICABILI

MAX LOADS

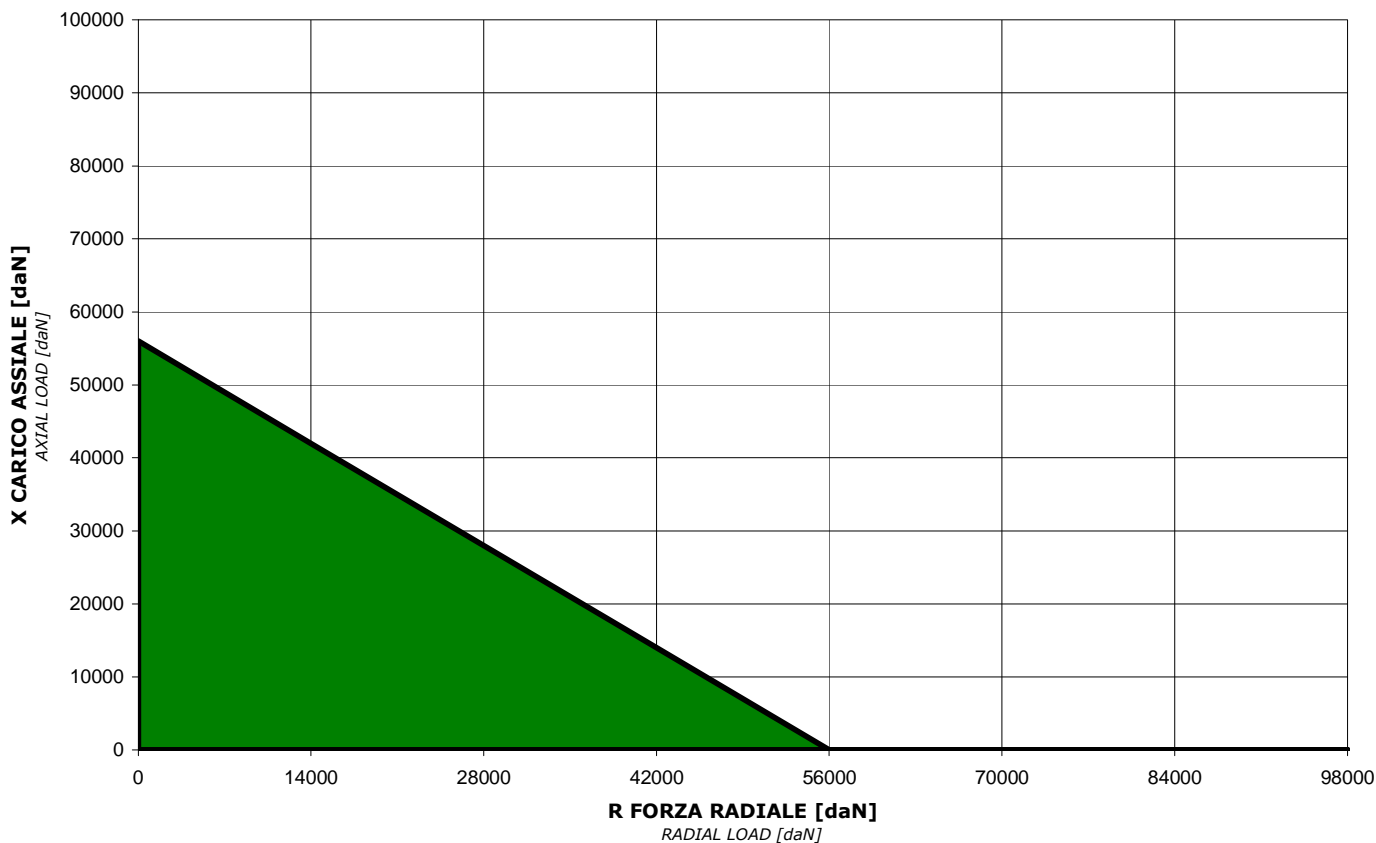

Carico assiale statico <i>Static axial load</i>	Carico radiale statico <i>Static radial load</i>	Momento ribaltante statico <i>Static overturning torque</i>
daN		daNm
56000	56000	11650

FORI PER L'ASSEMBLAGGIO SU DISCO ROTANTE

ASSEMBLING THREADED HOLES ON ROTATING DISK

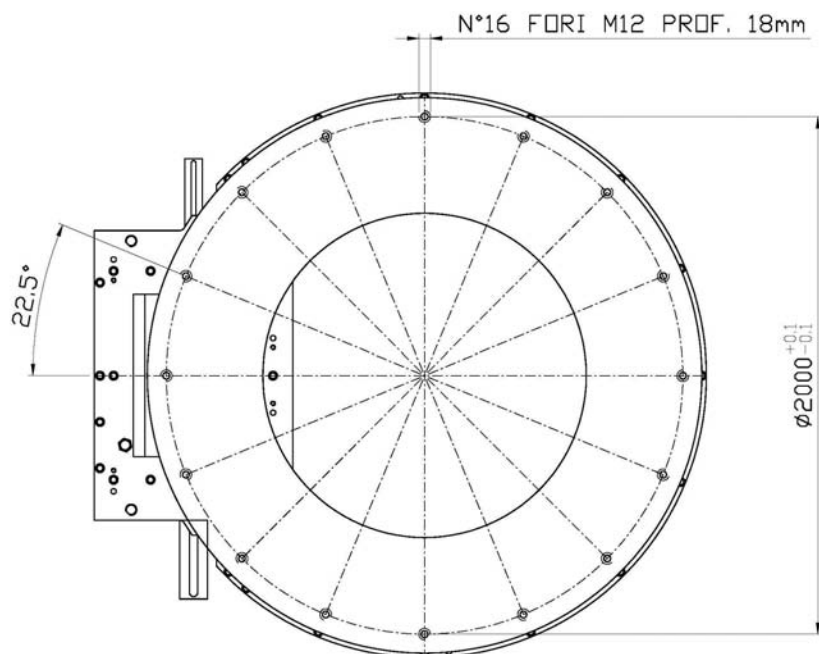

ANELLO ROTANTE ROTARY INDEX RING AR2100

PESO / Weight Kg.1400

DISPONIBILE SU DISCO CAD
Available on CAD disc

FILE
W41953

 ROTANTE
ROTATING

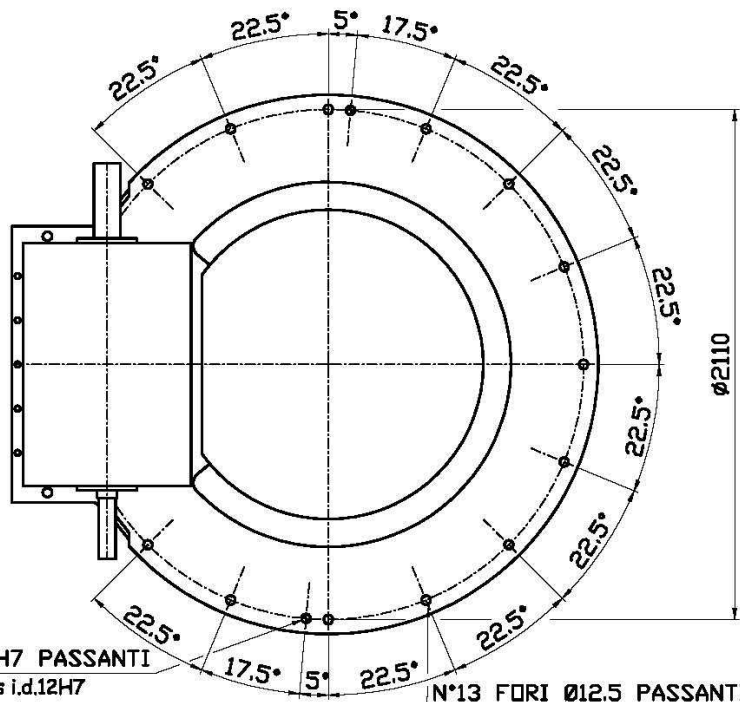

N°2 FORI Ø12H7 PASSANTI
N°2 through holes i.d.12H7

N°13 FORI Ø12.5 PASSANTI
N°13 through holes i.d.12.5

IL DISCO ROTANTE 2100 X 18 VIENE
FORNITO SU SPECIFICA RICHIESTA

the ring disc 2100 x 18 is
supplied only when required

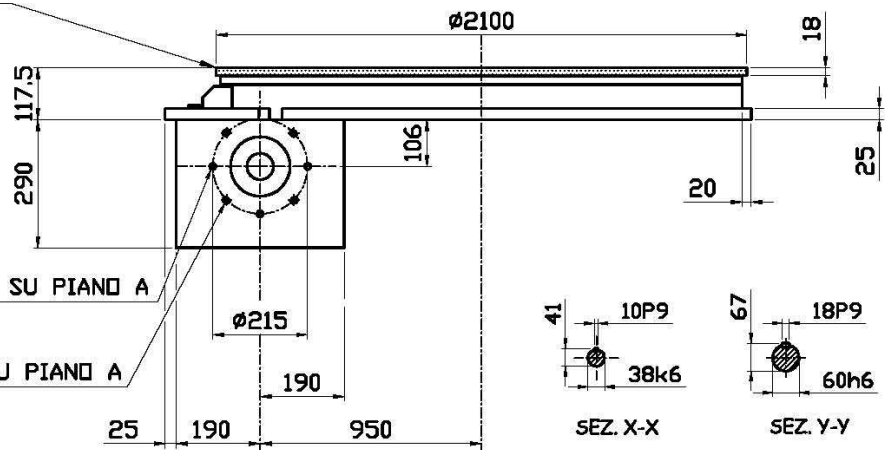

N°3 FORI Ø14H7 PROF.=20 ANCHE SU PIANO A
N°3 holes i.d. 14H7 dept=20 on plane A too

N°4 FORI M14 PROF.=30 ANCHE SU PIANO A
N°4 M14 holes dept=30 on plane A too

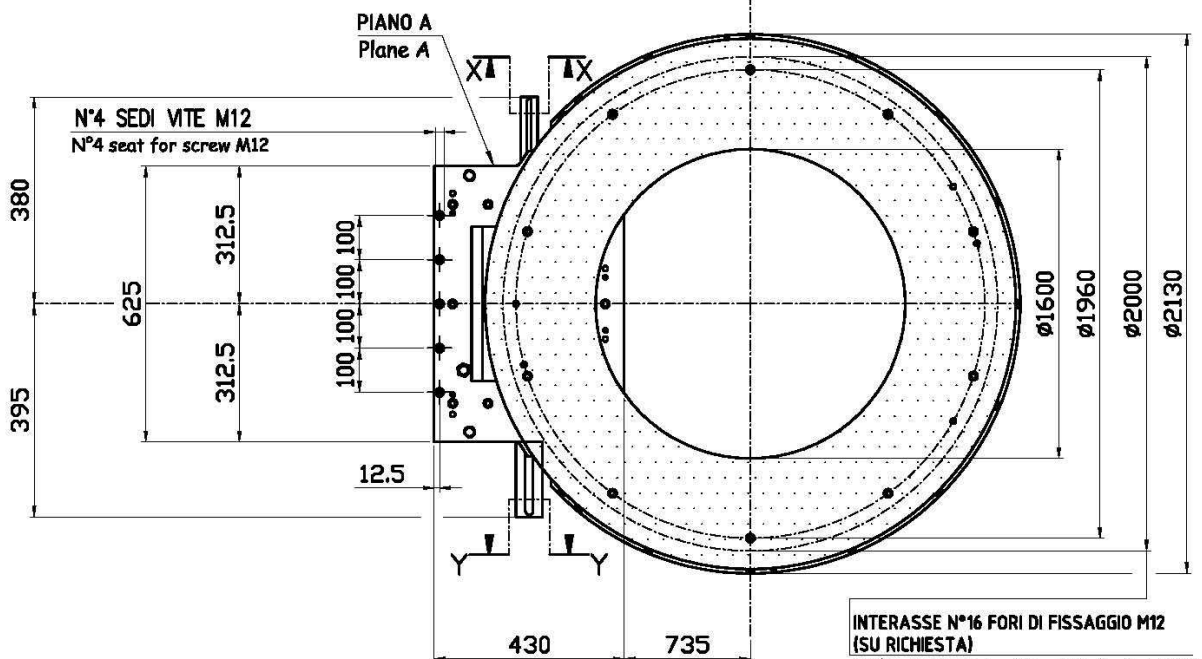
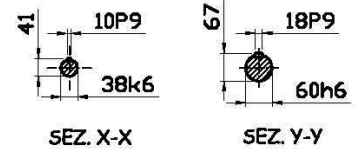

INTERASSE N°16 FORI DI FISSAGGIO M12
(SU RICHIESTA)
C./C. distance of mount. holes M12
(on request)

TEMPI DI SPOSTAMENTO

INDEX TIME

R. riduzione <i>R. ratio</i>	Cicli/min <i>Cycles/min</i>	Tempo Ciclo <i>Cycle time</i> (s)	tempo di spostamento (s) riferito all'angolo di camma (°) <i>Index time (s) referred to cam angle (°)</i>								
			120	150	180	210	240	270	300	315	330

4 p. – 50 Hz – 1400 rpm

10/1	140,00	0,43	0,143	0,179	0,214	0,250	0,286	0,321	0,357	0,375	0,393
15/1	93,33	0,64	0,214	0,268	0,321	0,375	0,429	0,482	0,536	0,563	0,589
16/1	87,50	0,69	0,229	0,286	0,343	0,400	0,457	0,514	0,571	0,600	0,629
20/1	70,00	0,86	0,286	0,357	0,429	0,500	0,571	0,643	0,714	0,750	0,786
25/1	56,00	1,07	0,357	0,446	0,536	0,625	0,714	0,804	0,893	0,938	0,982
28/1	50,00	1,20	0,400	0,500	0,600	0,700	0,800	0,900	1,000	1,050	1,100
32/1	43,75	1,37	0,457	0,571	0,686	0,800	0,914	1,029	1,143	1,200	1,257
40/1	35,00	1,71	0,571	0,714	0,857	1,000	1,143	1,286	1,429	1,500	1,571
49/1	28,57	2,10	0,700	0,875	1,050	1,225	1,400	1,575	1,750	1,838	1,925
50.8/1	27,56	2,18	0,726	0,907	1,089	1,270	1,451	1,633	1,814	1,905	1,996
56/1	25,00	2,40	0,800	1,000	1,200	1,400	1,600	1,800	2,000	2,100	2,200

6 p. – 50 Hz – 900 rpm

10/1	90,00	0,67	0,222	0,278	0,333	0,389	0,444	0,500	0,556	0,583	0,611
15/1	60,00	1,00	0,333	0,417	0,500	0,583	0,667	0,750	0,833	0,875	0,917
16/1	56,25	1,07	0,356	0,444	0,533	0,622	0,711	0,800	0,889	0,933	0,978
20/1	45,00	1,33	0,444	0,556	0,667	0,778	0,889	1,000	1,111	1,167	1,222
25/1	36,00	1,67	0,556	0,694	0,833	0,972	1,111	1,250	1,389	1,458	1,528
28/1	32,14	1,87	0,622	0,778	0,933	1,089	1,244	1,400	1,556	1,633	1,711
32/1	28,13	2,13	0,711	0,889	1,067	1,244	1,422	1,600	1,778	1,867	1,956
40/1	22,50	2,67	0,889	1,111	1,333	1,556	1,778	2,000	2,222	2,333	2,444
49/1	18,37	3,27	1,089	1,361	1,633	1,906	2,178	2,450	2,722	2,858	2,994
50.8/1	17,72	3,39	1,129	1,411	1,693	1,976	2,258	2,540	2,822	2,963	3,104
56/1	16,07	3,73	1,244	1,556	1,867	2,178	2,489	2,800	3,111	3,267	3,422

4 p. – 60 Hz – 1750 rpm

10/1	175,00	0,34	0,114	0,143	0,171	0,200	0,229	0,257	0,286	0,300	0,314
15/1	116,67	0,51	0,171	0,214	0,257	0,300	0,343	0,386	0,429	0,450	0,471
16/1	109,38	0,55	0,183	0,229	0,274	0,320	0,366	0,411	0,457	0,480	0,503
20/1	87,50	0,69	0,229	0,286	0,343	0,400	0,457	0,514	0,571	0,600	0,629
25/1	70,00	0,86	0,286	0,357	0,429	0,500	0,571	0,643	0,714	0,750	0,786
28/1	62,50	0,96	0,320	0,400	0,480	0,560	0,640	0,720	0,800	0,840	0,880
32/1	54,69	1,10	0,366	0,457	0,549	0,640	0,731	0,823	0,914	0,960	1,006
40/1	43,75	1,37	0,457	0,571	0,686	0,800	0,914	1,029	1,143	1,200	1,257
49/1	35,71	1,68	0,560	0,700	0,840	0,980	1,120	1,260	1,400	1,470	1,540
50.8/1	34,45	1,74	0,581	0,726	0,871	1,016	1,161	1,306	1,451	1,524	1,597
56/1	31,25	1,92	0,640	0,800	0,960	1,120	1,280	1,440	1,600	1,680	1,760

6 p. – 60 Hz – 1150 rpm

10/1	115,00	0,52	0,174	0,217	0,261	0,304	0,348	0,391	0,435	0,457	0,478
15/1	76,67	0,78	0,261	0,326	0,391	0,457	0,522	0,587	0,652	0,685	0,717
16/1	71,88	0,83	0,278	0,348	0,417	0,487	0,557	0,626	0,696	0,730	0,765
20/1	57,50	1,04	0,348	0,435	0,522	0,609	0,696	0,783	0,870	0,913	0,957
25/1	46,00	1,30	0,435	0,543	0,652	0,761	0,870	0,978	1,087	1,141	1,196
28/1	41,07	1,46	0,487	0,609	0,730	0,852	0,974	1,096	1,217	1,278	1,339
32/1	35,94	1,67	0,557	0,696	0,835	0,974	1,113	1,252	1,391	1,461	1,530
40/1	28,75	2,09	0,696	0,870	1,043	1,217	1,391	1,565	1,739	1,826	1,913
49/1	23,47	2,56	0,852	1,065	1,278	1,491	1,704	1,917	2,130	2,237	2,343
50.8/1	22,64	2,65	0,883	1,104	1,325	1,546	1,767	1,988	2,209	2,319	2,430
56/1	20,54	2,92	0,974	1,217	1,461	1,704	1,948	2,191	2,435	2,557	2,678

rapporti di riduzione
reduction ratio

standard	consigliati
standard	advised

POSIZIONE DI MONTAGGIO UNITA' MOTRICE

POWER DRIVE UNIT ASSEMBLING POSITION

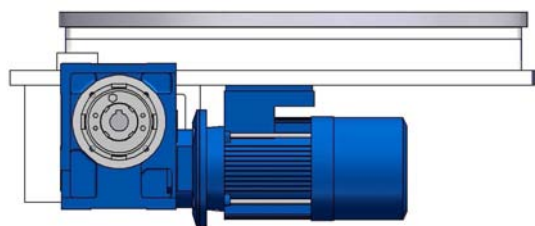

A

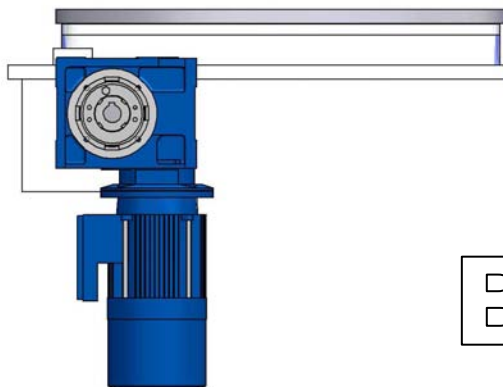

B

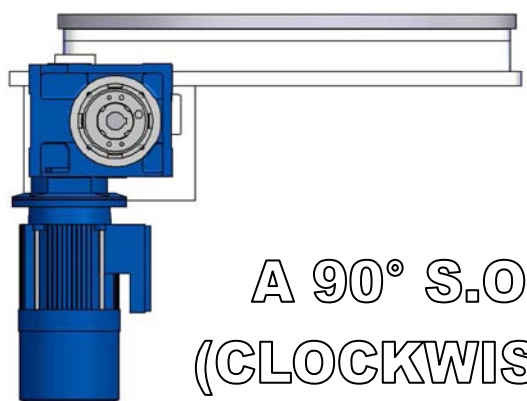

A 90° S.O.
(CLOCKWISE)

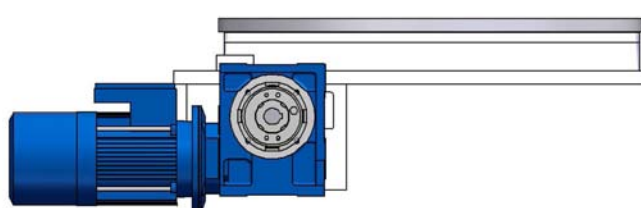

D

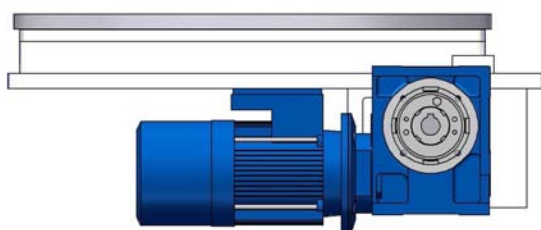

E

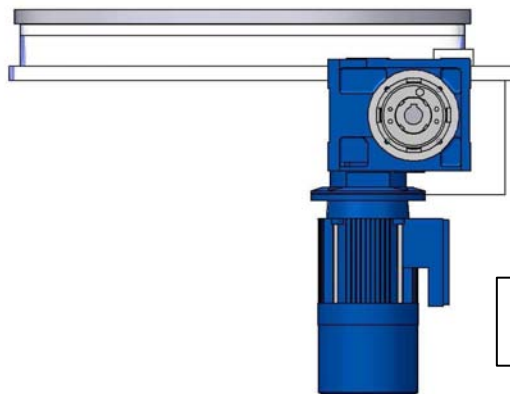

F



E 90° S.A.O.
(COUNTERCLOCKWISE)

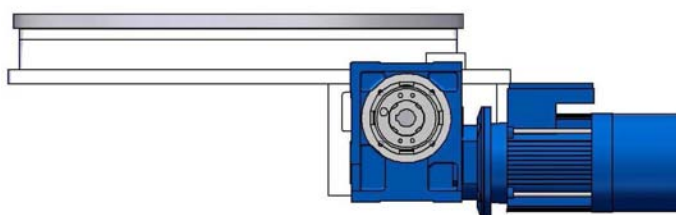

H

OUR MAIN WORLD REPRESENTATIVES AND DISTRIBUTORS

EUROPE

OUR GERMAN SISTER COMPANY		
AUTOROTOR DEUTSCHLAND GMBH Mühlweg 47 67117 Limburgerhof Tel. +49/623661003 - Fax +49/623661004 e-mail: info@autorotor.de www.autorotor.de		
BENELUX	CZECH REPUBLIC	
VERMEIRE BELTING Rue de la Filature, 41 B-4800 Ensival (Verviers) Ph. +32/87 322360 - Fax +32/92381227 w.vandeputte@vermeire.com www.vermeire.com	BIBUS S.R.O. Videnska, 125 63927 Brno CS Ph. +420/547125326 - Fax +420/547125310 kelbl@bibus.cz www.bibus.cz	
DENMARK	FRANCE	GREECE
BONDY LMT A/S Hassellunden 14 DK 2765 Smorum Tel. +45 7015 1414 - Fax.: +45 4464 1416 info@bondylmt.dk www.bondylmt.dk	BERNAY AUTOMATION S.A. 1, Rue de Menneval 27304 Bernay Cedex Ph. +33/232473510 - Fax +33/232430188 info@bernay-automation.com www.bernay-automation.com	PNEUMATEC IND. AUT. SYSTEMS Nevrokopiou, 18 11855 Athens EL Ph. +30-210-3412101 - Fax +30-210-3413930 pantosit@otenet.gr www.otenet.gr
MALTA	POLAND	SLOVAK REPUBLIC
RAYAIR AUTOMATION LTD. Corradino Industrial Estate, KW 23 G PAOLA, PLA 08 Malta Ph. +356 21 672497 - Fax +356 21 805181 info@rayair-automation.com www.rayair-automation.com	TB-AUTOMATION A. Legionow, 10 34300 Zywiec - Polonia Tel./Fax 0048/126371377 biuro@tb-automation.com.pl - http://www.tb-automation.com.pl	BIBUS S.R.O. Trnavska 31 - SK-949 01 Nitra Tel. +421 037 7777 911 - Fax +421 037 7777 999 bibus@bibus.sk http://www.bibus.sk
SLOVENIA	SPAIN	TURKEY
LIPRO d.o.o. Dekani 20a 6271, Dekani - Capodistria Ph. 00386-56251343 - Fax 00386-56251344 info@lipro.si www.lipro.si	COTRANSA COMERCIAL DE TRANSMISIONES S.A. P.I. Trobika, C/Landeta, 4 48100 Mungia - Bizkaia Ph. +34/944710102 - Fax +34/944710345 cotransa@cotransa.net www.cotransa.net	GIMATIC OTOMASYON TICARET LTD. STI. Perpa Tic. Mrk. A – Blok Kat: 11 No: 1478 Okmeydani / ISTANBUL Ph. +90 (212) 2108391 Fax +90 (212) 2108398 tsjtucker@gimatic.com.tr

AMERICA

(U.S.A.) ILLINOIS, MICHIGAN, INDIANA, OHIO	(U.S.A.) TEXAS, LOUISIANA, ARKANSAS, OKLAHOMA, NEW MEXICO
EASOM AUTOMATION SYSTEMS INC. 32471 Industrial Dr Madison Heights MI 48071 Ph. +1/248-307-0650 - Fax +1/248-307-0701 sales@easomeng.com www.easomeng.com	BURNS CONTROLS 13735 Beta Road Dallas Texas 75244 Ph. +1/972-233-6712 - Fax +1/972-233-8039 burns@burnscontrols.com www.burnscontrols.com
CANADA	BRAZIL
SEMPRESS Pneumatics 3580A Wolfedale Rd. Mississauga, Ont. Canada - L5C 2V6 Tel. +1/905 949 2324 Fax +1/905 949 1944 sempress@sempress.ca http://www.sempress.ca	AXIOS COMERCIO DE MAQUINAS E EQUIPAMENTOS LTDA Rua Taipas, 632-8A, Bairro Barcelona, 09560-200 São Caetano Do Sul, São Paulo Ph. (55) (11) 4221-8003 - Fax (55) (11) 2311-4942 axios@axiosequipamentos.com.br - www.axiosequipamentos.com.br

ASIA

SOUTH KOREA	CHINA
TAEYOUNG MOTIVE Taeyoung BLDG, 60, Solbat-ro 21944 – Yeonsu-gu, Incheon Ph. +82 32 463 1617 - Fax +82 32 465 2324 chpeak@tymotive.co.kr www.tymotive.co.kr	PEKO AUTOMATION TECHNOLOGY (SUZHOU) CO., LTD No.2 Kecheng Road, Suzhou Industrial Part, Jiangsu Province – China Ph. and Fax +86 512 65205455 yangx@sz-peko.com www.sz-peko.com
SINGAPORE	INDIA
SERVO DYNAMICS PTE LTD. 10 Kaki Bukit Road, 1 01-30 Kaki Bukit Ind. Build. 416175 Ph. +65/8440288 - Fax +65/8440070 servodynamics@servo.com.sg www.servo.com.sg	ARVI HITECH 210, Anna Street - Devar Nagar, Chennai 600050 Tel./Fax +914426544748 Mobile +919840601278 ravi@arvihitech.co.in http://www.arvihitech.com

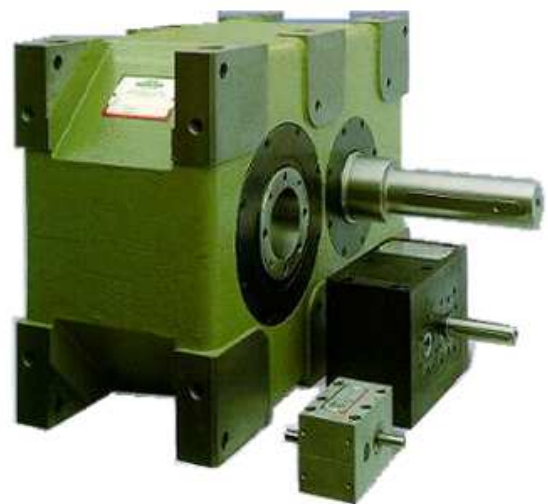

TEC-IT.COM