

**Roues en fonte DIN 8187  
pour chaînes de transmission**

**Gietijzeren kettingwielen voor  
rollenkettingen DIN 8187**

**Cast iron chain wheels for  
roller chains DIN 8187**

**Kettenräder aus Grauguss  
für Rollenketten DIN 8187**

**3/8" x 7/32" (ØR 6.35mm) 06B-1-2-3**

Roues en fonte	pour chaînes de transmission	DIN 8187    ISO/R606
Gietijzeren kettingwielen	voor rollenkettingen	
Cast iron chain wheels	for roller chains	
Kettenräder aus Grauguss	für Rollenketten	

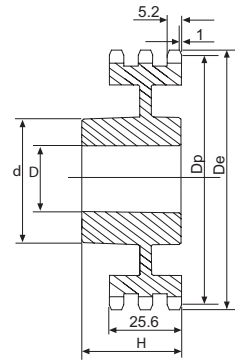
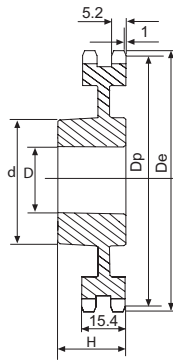
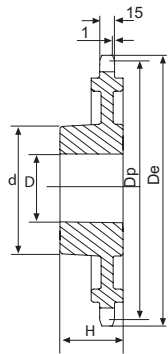

SIMPLEX								DUPLEX					TRIPLEX				
Z	De	Dp	d	D	H	kg	art. n°	d	D	H	kg	art. n°	d	D	H	kg	art. n°
38	119.5	115.34	70	19	32	1.12	105B106038F	80	19	40	1.56	1052106038F	90	23	56	2.48	105B306038F
45	140.7	136.54	70	19	32	1.30	105B106045F	80	19	40	2.06	105B206045F	90	23	56	3.56	105B306045F
57	176.9	172.91	70	19	32	1.55	105B106057F	80	19	40	2.30	105B206057F	90	23	56	3.97	105B306057F
76	234.9	230.49	70	19	32	2.00	105B106076F	80	19	40	3.02	105B206076F	10	23	56	4.52	105B306076F
95	292.5	288.08	80	19	40	3.83	105B106095F	90	19	45	4.68	105B206095F	100	23	56	6.12	105B306095F
114	349.6	345.68	80	19	40	4.05	105B106114F	95	19	45	5.90	105B206114F	100	23	56	7.45	105B306114F
150	459.2	454.82	90	23	45	4.98	105B106150F	100	23	50	6.42	105B206150F	125	23	60	8.03	105B306150F

!! remarque / opmerking / observation / Bemerkung ----> pg 0 !!

**1/2" x 5/16" (ØR 8.51mm) 08B-1-2-3**

Roues en fonte	pour chaînes de transmission	DIN 8187    ISO/R606
Gietijzeren kettingwielen	voor rollenkettingen	
Cast iron chain wheels	for roller chains	
Kettenräder aus Grauguss	für Rollenketten	

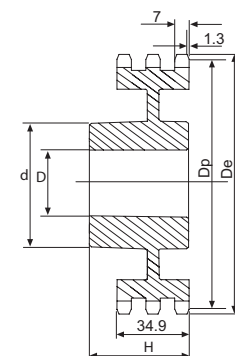
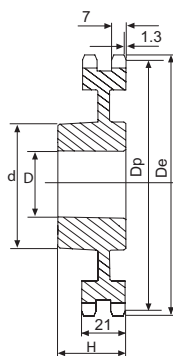
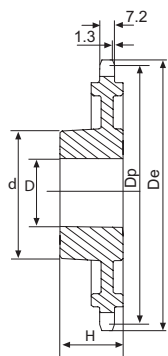

SIMPLEX								DUPLEX					TRIPLEX				
Z	De	Dp	d	D	H	kg	art. n°	d	D	H	kg	art. n°	d	D	H	kg	art. n°
38	158.6	153.80	70	19	40	1.56	105B108038F	90	23	50	3.15	105B208038F	100	23	60	4.45	105B308038F
45	188.0	182.07	70	19	40	1.95	105B108045F	90	23	50	3.56	105B208045F	100	23	60	5.85	105B308045F
57	236.4	230.54	70	19	40	2.46	105B108057F	90	23	50	4.00	105B208057F	100	23	60	6.28	105B308057F
76	313.3	307.33	80	23	40	4.20	105B108076F	100	23	56	6.35	105B208076F	100	23	60	8.60	105B308076F
95	390.1	384.11	80	23	45	5.45	105B108095F	100	23	56	8.00	105B208095F	120	23	67	11.90	105B308095F
114	466.9	460.90	80	23	45	8.35	105B108114F	100	23	63	11.90	105B208114F	120	23	67	12.7	105B308114F

!! remarque / opmerking / observation / Bemerkung ----> pg 0 !!

**5/8" x 3/8" (ØR 10.16mm) 10B-1-2-3**

Roues en fonte	pour chaînes de transmission	DIN 8187	ISO/R606
Gietijzeren kettingwielen	voor rollenkettingen		
Cast iron chain wheels	for roller chains		
Kettenräder aus Grauguss	für Rollenketten		

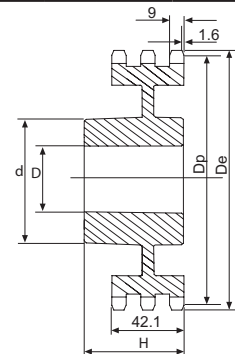
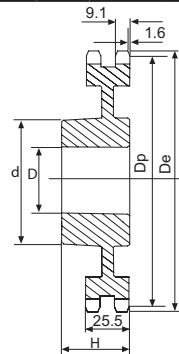
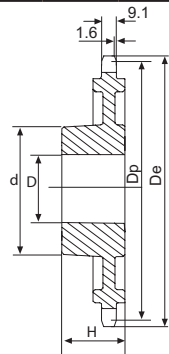

SIMPLEX								DUPLEX					TRIPLEX				
Z	De	Dp	d	D	H	kg	art. n°	d	D	H	kg	art. n°	d	D	H	kg	art. n°
38	199.2	192.24	80	19	40	2.32	105B110038F	100	29	50	4.56	105B210038F	100	31	60	6.50	105B310038F
45	235.0	227.58	80	19	40	2.88	105B110045F	100	29	50	4.93	105B210045F	100	31	60	7.04	105B310045F
57	296.0	288.18	90	23	45	4.30	105B110057F	100	29	56	6.50	105B210057F	100	31	63	8.00	105B310057F
76	392.1	384.16	90	23	50	7.00	105B110076F	100	29	63	9.10	105B210076F	110	34	67	12.00	105B310076F
95	488.5	480.14	100	23	56	10.65	105B110095F	110	29	63	12.60	105B210095F	125	34	70	19.40	105B310095F
114	584.1	576.13	100	23	56	14.50	105B110114F	125	29	70	17.80	105B210114F	125	34	80	24.00	105B310114F

!! remarque / opmerking / observation / Bemerkung ----> pg 0 !!

**3/4" x 7/16" (ØR 12.07mm) 12B-1-2-3**

Roues en fonte	pour chaînes de transmission	DIN 8187	ISO/R606
Gietijzeren kettingwielen	voor rollenkettingen		
Cast iron chain wheels	for roller chains		
Kettenräder aus Grauguss	für Rollenketten		

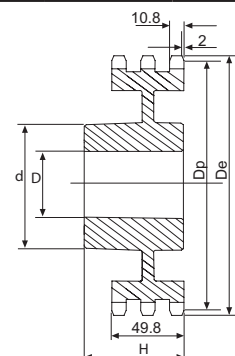
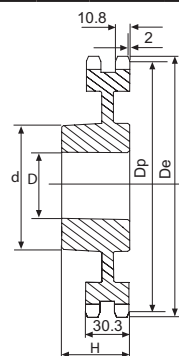
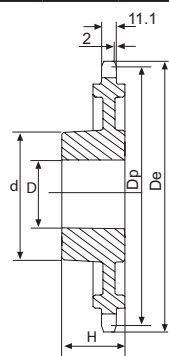

SIMPLEX								DUPLEX					TRIPLEX				
Z	De	Dp	d	D	H	kg	art. n°	d	D	H	kg	art. n°	d	D	H	kg	art. n°
38	239.0	230.69	100	23	56	4.75	105B112038F	110	29	63	7.50	105B212038F	140	30	70	10.00	105B312038F
45	282.5	273.10	100	23	56	5.90	105B112045F	110	29	63	8.30	105B212045F	140	30	70	13.30	105B312045F
57	354.0	345.81	100	29	56	6.45	105B112057F	120	29	63	10.30	105B212057F	140	39	70	15.25	105B312057F
76	469.9	460.99	100	29	56	12.30	105B112076F	135	29	63	15.20	105B212076F	160	39	75	27.20	105B312076F
95	585.1	576.17	100	29	65	15.40	105B112095F	135	29	70	20.20	105B212095F	170	39	82	36.40	105B312095F
114	700.6	691.36	100	29	65	24.80	105B112114F	135	29	70	30.40	105B212114F	170	49	82	41.10	105B312114F

!! remarque / opmerking / observation / Bemerkung ----> pg 0 !!

<b>1" x 17.02mm (ØR 15.88mm) 16B-1-2-3</b>																			
Roues en fonte		pour chaînes de transmission										<b>DIN 8187 ISO/R606</b>							
Gietijzeren kettingwielen		voor rollenkettingen																	
Cast iron chain wheels		for roller chains																	
Kettenräder aus Grauguss		für Rollenkettens																	
		<b>SIMPLEX</b>						<b>DUPLEX</b>						<b>TRIPLEX</b>					
Z	De	Dp	d	D	H	kg	art. n°	d	D	H	kg	art. n°	d	D	H	kg	art. n°		
38	320.0	307.59	110	29	65	8.26	105B116038F	140	39	75	16.45	105B216038F	160	44	100	25.40	105B316038F		
45	377.0	364.12	125	29	70	10.75	105B116045F	150	39	75	19.20	105B216045F	160	44	100	33.60	105B316045F		
57	474.0	461.07	125	34	70	12.90	105B116057F	170	39	90	29.50	105B216057F	165	44	100	44.70	105B316057F		
76	627.0	614.65	140	34	80	24.70	105B116076F	175	39	95	46.30	105B216076F	200	44	110	63.10	105B316076F		
95	781.0	768.22	140	39	80	32.00	105B116095F	175	44	95	53.00	105B216095F	200	49	110	77.00	105B316095F		
114	933.0	921.81	140	39	80	45.50	105B116114F	175	44	95	74.00	105B216114F	200	49	115	97.00	105B316114F		

!! remarque / opmerking / observation / Bemerkung ----> pg 0 !!

<b>1"1/4 x 3/4" (ØR 19.05mm) 20B-1-2-3</b>																			
Roues en fonte		pour chaînes de transmission										<b>DIN 8187 ISO/R606</b>							
Gietijzeren kettingwielen		voor rollenkettingen																	
Cast iron chain wheels		for roller chains																	
Kettenräder aus Grauguss		für Rollenkettens																	
		<b>SIMPLEX</b>						<b>DUPLEX</b>						<b>TRIPLEX</b>					
Z	De	Dp	d	D	H	kg	art. n°	d	D	H	kg	art. n°	d	D	H	kg	art. n°		
38	399.6	384.49	125	35	70	12.30	105B120038F	140	44	90	24.80	105B220038F	180	56	110	52.00	105B320038F		
45	470.3	455.17	125	35	70	16.48	105B120045F	140	44	90	35.48	105B220045F	180	56	110	65.20	105B320045F		
57	591.5	576.36	135	40	80	25.60	105B120057F	160	50	100	43.00	105B220057F	180	60	125	71.50	105B320057F		
76	783.5	768.32	140	40	90	29.10	105B120076F	180	50	100	62.50	105B220076F	200	60	140	115.00	105B320076F		

!! remarque / opmerking / observation / Bemerkung ----> pg 0 !!

**1"1/2 x 1" (ØR 25.4mm) 24B-1-2-3**

Roues en fonte	pour chaînes de transmission	DIN 8187    ISO/R606
Gietijzeren kettingwielen	voor rollenkettingen	
Cast iron chain wheels	for roller chains	
Kettenräder aus Grauguss	für Rollenketten	

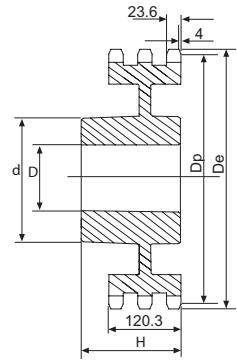
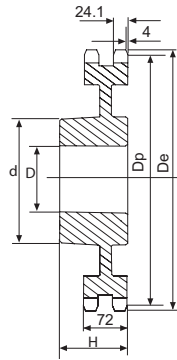
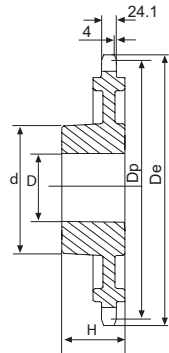

**SIMPLEX**

**DUPLEX**

**TRIPLEX**

Z	De	Dp	d	D	H	kg	art. n°	d	D	H	kg	art. n°	d	D	H	kg	art. n°
38	476.2	461.39	140	45	90		105B124038F	180	45	100		105B224038F	200	60	150		105B324038F
45	561.2	546.20	140	45	90		105B124045F	180	45	100		105B224045F	200	60	150		105B324045F
57	706.5	691.63	160	45	100		105B124057F	200	55	110		105B224057F	200	70	150		105B324057F
76	936.9	921.98	170	45	100		105B124076F	220	55	120		105B224076F					105B324076F
95	1167.3	1152.33	200	50	125		105B124095F	220	55	140		105B224095F					105B324095F

!! remarque / opmerking / observation / Bemerkung ----> pg 0 !!